

19 271 VP0 **KENSINGTON 2-WAY DIVERTER**



PRODUCT DESCRIPTION

- Colour: chrome /Swarovski® Crystal
- Corona handle
- set for final installation (for 29 712)
- without concealed body
- escutcheon with wall sealing
- screwable
- adjustable installation depth
- GROHE Long-Life finish
- for use with rough-in valve 29 712

19 271 VP0 KENSINGTON 2-WAY DIVERTER

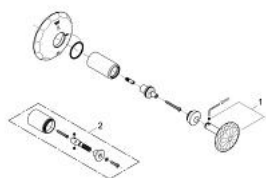

SPARE PARTS, 7月 2005 – now

1: Handle (Order-nr. 18089VP0)

2: Extension (Order-nr. 45979000)*

* Optional accessories