

19 272 EN0 KENSINGTON <P>2-WAY DIVERTER</P>



PRODUCT DESCRIPTION

- Colour: brushed nickel
- Lever handle
- set for final installation 29 712 000
- without concealed body
- screw flange
- screwable
- adjustable installation depth
- GROHE LongLife finish
- for use with rough-in valve 29 712

19 272 EN0 KENSINGTON <P>2-WAY DIVERTER</P>

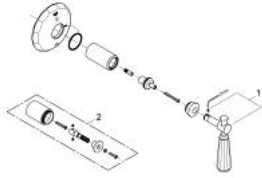

SPARE PARTS, March 2005 – now

1: Lever (Spare part-nr. 18090EN0)

2: Extension (Spare part-nr. 45979000)*

* Optional accessories