

19 325 EN0 **BRIDGEFORD 2-WAY DIVERTER**



PRODUCT DESCRIPTION

- Colour: brushed nickel
- set for final installation (for 29 712)
- without concealed body
- escutcheon with wall sealing
- screwable
- adjustable installation depth

19 325 EN0 **BRIDGEFORD 2-WAY DIVERTER**

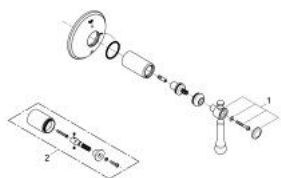

SPARE PARTS, 6月 2005 – now

1: Lever (Order-nr. 47789EN0)

2: Extension (Order-nr. 45979000)*

* Optional accessories