

19 442 000 GROHE ONDUS THERMOSTAT WITH INTEGRATED 2-WAY DIVERTER FOR BATH OR SHOWER WITH MORE THAN ONE OUTLET

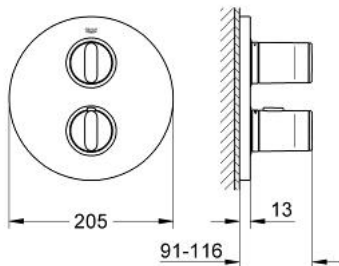

PRODUCT DESCRIPTION

- Colour: chrome
- set for final installation for
- GROHE Rapido T 35 500 000
- without concealed body
- temperature scale handle with GROHE SafeStop at 38°C
- Aquadimmer with multiple function
- shut off and flow control
- diverter for 2 outlets
- metal handles
- metal escutcheon
- escutcheon- and shaft-sealings
- covered fixing



19 442 000 GROHE ONDUS THERMOSTAT WITH INTEGRATED 2-WAY DIVERTER FOR BATH OR SHOWER WITH MORE THAN ONE OUTLET

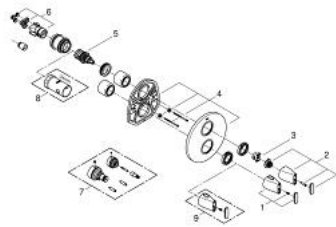

SPARE PARTS, 4月 2014 – now

- 1: Scale handle, metallic (Spare part-nr. 47795000)
 - 2: Handle for shut-off valve (Spare part-nr. 47796000)
 - 3: Stop ring (Spare part-nr. 10089000)
 - 4: Escutcheon (Spare part-nr. 47797000)
 - 5: Aquadimmer (Spare part-nr. 47364000)
 - 6: Adapter (Spare part-nr. 12701000)
 - 7: Extension set 27.5 mm (Spare part-nr. 47781000)*
 - 8: Socket spanner (Spare part-nr. 19332000)*
 - 9: Scale handle, metallic (Spare part-nr. 47798000)*
- * Optional accessories