

19 470 000 **GROHTHERM 3000 COSMOPOLITAN CONCEALED VALVE EXPOSED PART**



**PRODUCT DESCRIPTION**

- Colour: chrome
- set for final installation for
- 35 028 000
- GROHE Long-Life finish
- for GROHE concealed valves, 1/2", 3/4", 1"
- installation depth infinitely adjustable 20-80 mm
- metal escutcheon with wall sealing
- shut-off handle



19 470 000 **GROHTHERM 3000 COSMOPOLITAN CONCEALED VALVE EXPOSED PART**

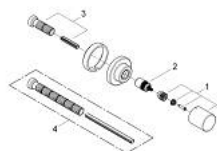

**SPARE PARTS**, 9月 2007 – now

1: Shut-off handle (Order-nr. 47806000)

2: Extension for spindle (Order-nr. 45204000)

3: Extension set, 80 mm (Order-nr. 45202000)

4: Extension set 200 mm (Order-nr. 45203000)\*

\* Optional accessories