

19 809 001 **COSTA L CONCEALED VALVE EXPOSED PART**

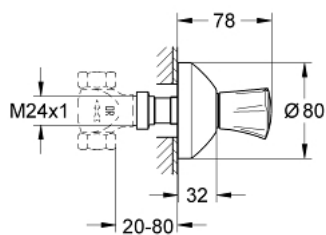

PRODUCT DESCRIPTION

- Colour: chrome
- set for final installation for
- 35 028 000
- for GROHE concealed valves, 1/2", 3/4", 1"
- installation depth infinitely adjustable 20-80 mm
- escutcheon with wall sealing
- screwable
- metal handle
- heat insulated
- marking: red
- GROHE Long-Life finish



19 809 001 **COSTA L CONCEALED VALVE EXPOSED PART**

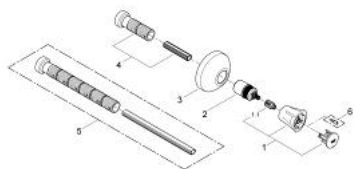

SPARE PARTS, 2月 2008 – now

1: Handle (Order-nr. 45994000)

1.1: Snap insert (Order-nr. 0538600M)

2: Extension for spindle (Order-nr. 45204000)

3: Escutcheon (Order-nr. 45219000)

4: Extension set, 80 mm (Order-nr. 45202000)

5: Extension set 200 mm (Order-nr. 45203000)*

6: Screw for Costa/Avina products (Order-nr. 48013000)*

* Optional accessories