

## 20 003 000 SENTOSA PILLAR TAP 1/2"

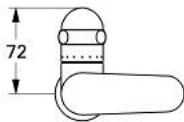

### PRODUCT DESCRIPTION

- Colour: chrome
- Carbodur ceramic headpart 1/2", 180°
- fastened cast spout with mousseur
- with small handle
- marking: blue
- GROHE LongLife finish

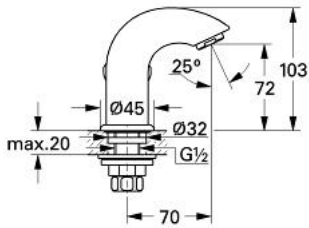

## 20 003 000 SENTOSA PILLAR TAP 1/2"

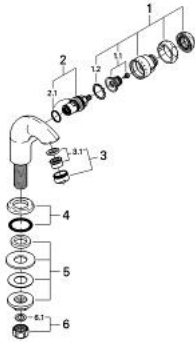

### SPARE PARTS, 1月 1993 – now

- 1: Handle (Spare part-nr. 45550IP0)
  - 1.1: Replacement handle connection kit (Spare part-nr. 45186000)
    - 1.1.1: O-ring  $\varnothing 18.2 \times \varnothing 1.7$  (Spare part-nr. 0392400M)
  - 1.2: Guide ring (Spare part-nr. 0202100M)
- 2: Ceramic headpart 1/2" (Spare part-nr. 45346000)
  - 2.1: O-ring  $\varnothing 18.2 \times \varnothing 1.7$  (Spare part-nr. 0392400M)
- 3: Mousseur (Spare part-nr. 13929000)
  - 3.1: Replacement flow control M22x1 and M24x1 (Spare part-nr. 45002000)
- 4: Escutcheon (Spare part-nr. 45552000)
- 5: Shank mounting kit (Spare part-nr. 45553000)
- 6: Coupling nut 1/2" (Spare part-nr. 1290100M)
  - 6.1: Fibre seal  $\varnothing 18,5 \times \varnothing 12 \times 2$  (Spare part-nr. 0138900M)