

20 013 IG0 SINFONIA PILLAR TAP 1/2"

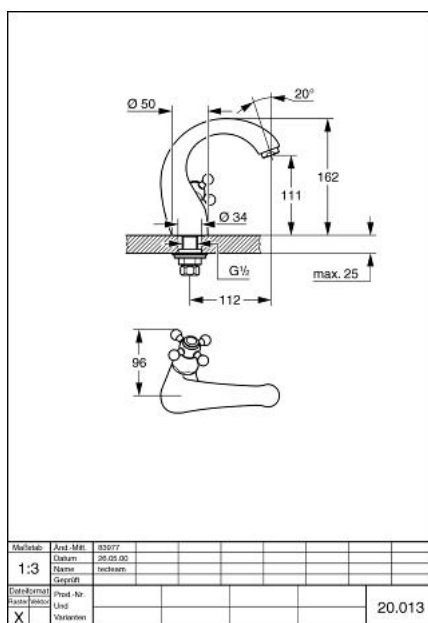

PRODUCT DESCRIPTION

- Colour: chrome/gold
- Carbodur ceramic headpart 1/2", 180°
- fastened cast spout with mousseur
- with cross handle
- GROHE Long-Life finish



20 013 IG0 SINFONIA PILLAR TAP 1/2"

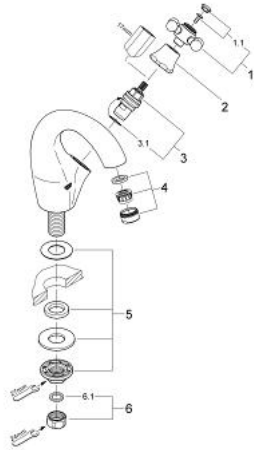

SPARE PARTS, 6月 2008 – now

- 1: Cross handle (Order-nr. 45291IG0)
- 1.1: Marking piece (Order-nr. 45305000)
- 2: Cover cap (Order-nr. 00061000)
- 3: Ceramic headpart 1/2" (Order-nr. 45346000)
- 3.1: O-ring Ø 18,2 x Ø 1.7 (Order-nr. 0392400M)
- 4: Mousseur (Order-nr. 13929G00)
- 5: Shank mounting kit (Order-nr. 45004000)
- 6: Coupling nut 1/2" (Order-nr. 1290100M)
- 6.1: Fibre seal Ø 18,5 x Ø 12 x 2 (Order-nr. 0138900M)