

## 20 014 IG0 SINFONIA 3-HOLE BASIN MIXER

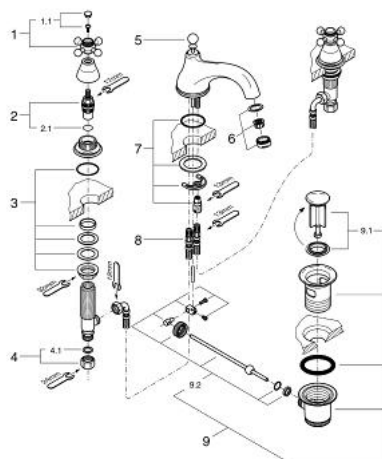

### SPARE PARTS, July 2008 – now

- 1: Sinfonia cross handles (Order-nr. 45291IG0)
- 1.1: Marking piece (Order-nr. 45305000)
- 2: Ceramic headpart, 1/2" (Order-nr. 45346000)
- 2.1: O-ring  $\varnothing 18.2 \times \varnothing 1.7$  (Order-nr. 0392400M)
- 3: Shank fastening assembly (Order-nr. 45025000)
- 4: Coupling nut 1/2" x 10.5 mm (Order-nr. 1290100M)
- 4.1: Fibre seal dia. 12x2 mm (Order-nr. 0138900M)
- 5: Pop-up rod (Order-nr. 07511IG0)
- 6: Mousseur (Order-nr. 13929G00)
- 7: Fixing set (Order-nr. 45249000)
- 8: Flexible hose (Order-nr. 45461000)
- 9: Pop-up waste set 1 1/4" (Order-nr. 28910IG0)
- 9.1: Plug (Order-nr. 07182G00)
- 9.2: Eccentric rod (Order-nr. 07052000)

## 20 014 IG0 SINFONIA 3-HOLE BASIN MIXER

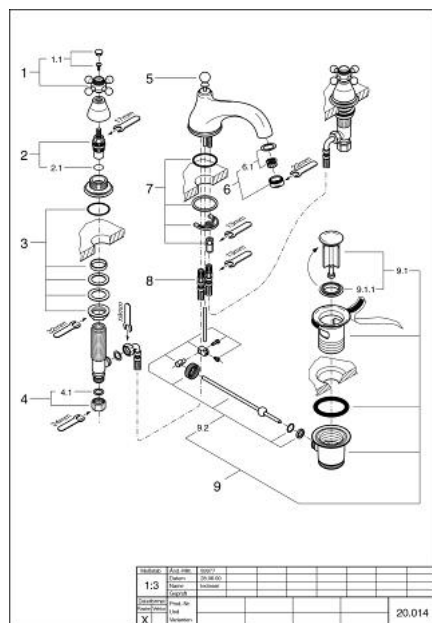

### SPARE PARTS, January 2000 – July 2008

- 1: Sinfonia cross handles (Order-nr. 45291IG0)
- 1.1: Marking piece (Order-nr. 45305000)
- 2: Ceramic headpart, 1/2" (Order-nr. 45346000)
- 2.1: O-ring  $\varnothing 18.2 \times \varnothing 1.7$  (Order-nr. 0392400M)
- 3: Shank mounting kit (Order-nr. 45286000)
- 4: Coupling nut 1/2" x 10.5 mm (Order-nr. 1290100M)
- 4.1: Fibre seal dia. 12x2 mm (Order-nr. 0138900M)
- 5: Pop-up rod (Order-nr. 07511IG0)
- 6: Mousseur (Order-nr. 13929G00)
- 6.1: Repl.kit f.Mousseur M22x1 and M24x1 (Order-nr. 45002000)
- 7: Shank mounting kit (Order-nr. 45226000)
- 8: Flexible hose (Order-nr. 45461000)
- 9: Pop-up waste set 1 1/4" (Order-nr. 28910IG0)
- 9.1: Plug (Order-nr. 07182G00)
- 9.2: Eccentric rod (Order-nr. 07052000)