

20 094 000 **ATLANTA PILLAR TAP 1/2"**

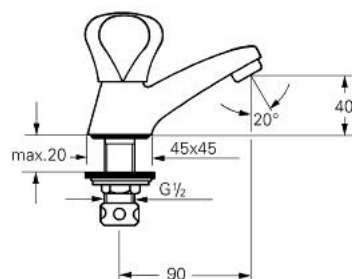

PRODUCT DESCRIPTION

- Colour: chrome
- ceramic headpart
- Trefflor handle
- mousseur
- marking: blue/red
- union nut with 10.5 mm drilling
- GROHE Long-Life finish

20 094 000 ATLANTA PILLAR TAP 1/2"

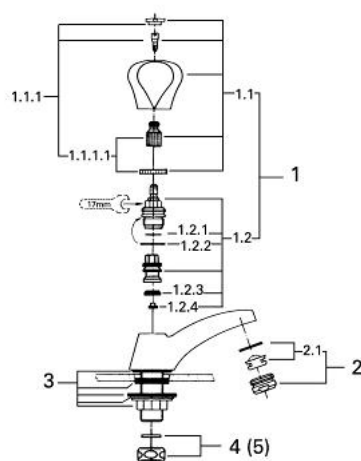

29.10.93
Weil

20.094

SPARE PARTS, 1月 1981 – now

- 1: Headpart 1/2" (Order-nr. 11086000)
- 1.1: Treflor handle 1/2" (Order-nr. 45124000)
- 1.1.1: Handle fixation (Order-nr. 45123000)
- 1.1.1.1: Snap insert (Order-nr. 0538600M)
- 1.2: Headpart 1/2" (Order-nr. 07146000)
- 1.2.1: Sealing washer $\varnothing 6 \times \varnothing 2$ (Order-nr. 0128300M)
- 1.2.2: O-ring $\varnothing 18.2 \times \varnothing 1.7$ (Order-nr. 0392400M)
- 1.2.3: Seal (Order-nr. 0529100M)
- 1.2.4: Mousseur (Order-nr. 13929000)
- 2: Mousseur (Order-nr. 13929000)
- 2.1: Replacement flow control M22x1 and M24x1 (Order-nr. 45002000)
- 3: Shank fastening assembly 1/2" (Order-nr. 45000000)
- 4: Coupling nut 1/2" (Order-nr. 1290100M)
- 4.1: Fibre seal $\varnothing 18,5 \times \varnothing 12 \times 2$ (Order-nr. 0138900M)
- 5: Coupling nut 1/2" x 14.5 mm (Order-nr. 1290200M)
- 5.1: Fibre seal $\varnothing 18,5 \times \varnothing 12 \times 2$ (Order-nr. 0138900M)