

## 20 134 EN0 BRIDGEFORD 3-HOLE BASIN MIXER



### PRODUCT DESCRIPTION

- Colour: brushed nickel
- GROHE LongLife finish
- mousseur
- side valves
- ceramic headparts 1/2", 90°
- pop-up waste set 1 1/4"
- pressure-proof, flexible connection hoses between spout and side valves
- without handles

## 20 134 EN0 BRIDGEFORD 3-HOLE BASIN MIXER

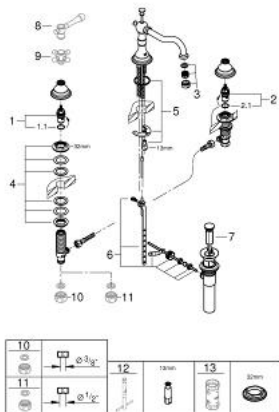

### SPARE PARTS, March 2016 – now

- 1: Ceramic headpart, 1/2" (Spare part-nr. 45882000)
- 2: Ceramic headpart, 1/2" (Spare part-nr. 45883000)
- 3: Mousseur (Spare part-nr. 48159EN0)
- 4: Shank fastening assembly (Spare part-nr. 45025000)
- 5: Shank mounting kit (Spare part-nr. 46249000)
- 6: Ball rod (Spare part-nr. 48332000)
- 8: Lever Handle (Spare part-nr. 18173EN0)\*
- 9: Sinfonia cross handles (Spare part-nr. 18733EN0)\*
- 10: Coupling nut 1/2" x 10.5 mm (Spare part-nr. 1290100M)\*
- 11: Coupling nut 1/2" x 14.5 mm (Spare part-nr. 1290200M)\*
- 12: Mounting wrench (Spare part-nr. 19017000)\*
- 13: Socket spanner (Spare part-nr. 19332000)\*

\* Optional accessories