

## 20 179 001 COSTA S PILLAR TAP

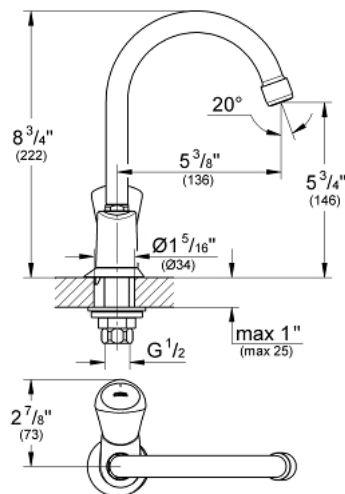

### PRODUCT DESCRIPTION

- Colour: chrome
- metal handle
- heat insulated
- screwable
- GROHE Long-Life finish
- ceramic headpart 1/2", 90°
- flow straightener
- swivel tubular spout
- swivel area 360°
- union nut 1/2" with 10.5 mm drilling



## 20 179 001 COSTA S PILLAR TAP

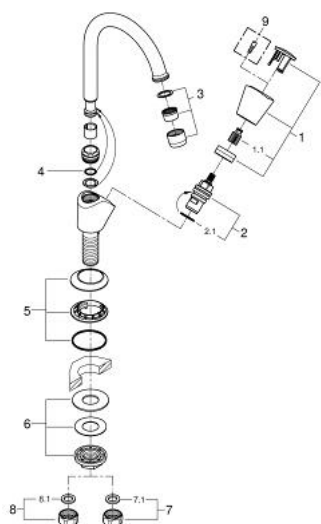

### SPARE PARTS, 4月 2014 – now

- 1: Handle (Order-nr. 45995000)
  - 1.1: Snap insert (Order-nr. 0538600M)
  - 2: Ceramic headpart 1/2" (Order-nr. 45882000)
  - 2.1: O-ring Ø 18.2 x Ø 1.7 (Order-nr. 0392400M)
  - 3: Mousseur (Order-nr. 48251000)
  - 4: O-ring Ø 12 x Ø 2 (Order-nr. 0128000M)
  - 5: Escutcheon (Order-nr. 45996000)
  - 6: Shank mounting kit (Order-nr. 45004000)
  - 7: Coupling nut 1/2" (Order-nr. 1290100M)
  - 7.1: Fibre seal Ø 18,5 x Ø 12 x 2 (Order-nr. 0138900M)
  - 8: Coupling nut 1/2" x 14.5 mm (Order-nr. 1290200M)
  - 8.1: Fibre seal Ø 18,5 x Ø 12 x 2 (Order-nr. 0138900M)
  - 9: Screw for Costa/Avina products (Order-nr. 48013000)\*
- \* Optional accessories