

20 190 000 **ALLURE 3-HOLE BASIN MIXER S-SIZE**

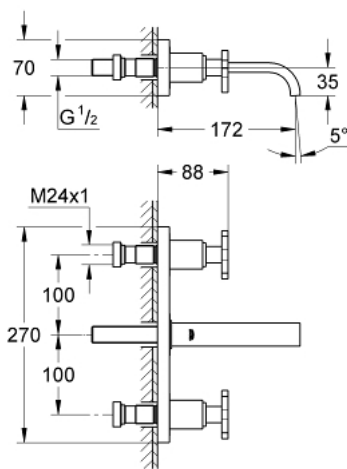

PRODUCT DESCRIPTION

- Colour: chrome
- wall mounted
- without concealed body
- set for final installation for
- 32 706 000
- with metal plate
- valves hot/cold with Carbidur ceramic headparts 1/2" - 180°
- GROHE Long-Life finish
- flow limiter 8 l/min.
- spout with mousseur
- center distance 200 mm
- projection 172 mm

20 190 000 **ALLURE 3-HOLE BASIN MIXER S-SIZE**

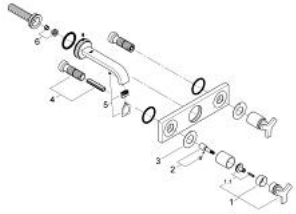

SPARE PARTS, 9月 2009 – now

1: Handle (Order-nr. 46611000)

1.1: Replacement handle connection kit (Order-nr. 45605000)

2: Extension for spindle (Order-nr. 45607000)

3: Sealing washer (Order-nr. 48046000)

4: Extension set, 80 mm (Order-nr. 45202000)

5: Mousseur (Order-nr. 13220000)

6: Flow limiter (Order-nr. 46324000)