

20 216 001 **CONCETTO 3-HOLE BASIN MIXER** **L-SIZE**

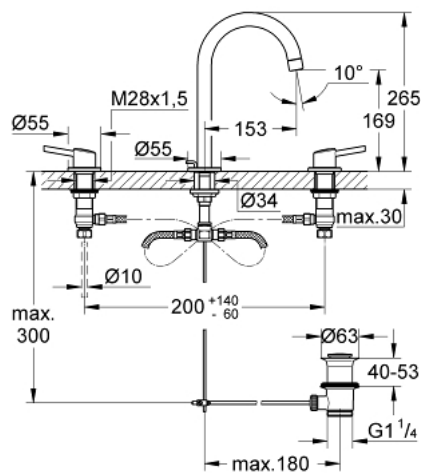

PRODUCT DESCRIPTION

- Colour: chrome
- ceramic headpart
- GROHE Long-Life finish
- GROHE FastFixation installation system with centering support
- spout with mousseur
- pop-up waste set 1 1/4"
- pressure-proof, flexible connection hoses
- pressure-proof, flexible connection hoses between middle-body and side valves
- union nut with 10.5 mm drilling

20 216 001 **CONCETTO 3-HOLE BASIN MIXER** **L-SIZE**



SPARE PARTS, February 2019 – now

- 1: Handle pair (Order-nr. 48310000)
 - 2: Ceramic headpart, 1/2" (Order-nr. 45882000)
 - 2.1: O-ring $\varnothing 18.2 \times \varnothing 1.7$ (Order-nr. 0392400M)
 - 3: Ceramic headpart, 1/2" (Order-nr. 45883000)
 - 3.1: O-ring $\varnothing 18.2 \times \varnothing 1.7$ (Order-nr. 0392400M)
 - 4: Coupling nut 1/2" x 10.5 mm (Order-nr. 1290100M)
 - 4.1: Fibre seal dia. 12x2 mm (Order-nr. 0138900M)
 - 5: Mousseur (Order-nr. 06574000)
 - 6: Pop-up rod (Order-nr. 65196000)
 - 7: Fixing clamp (Order-nr. 6554100M)
 - 8: Pop-up waste set 1 1/4" (Order-nr. 28910000)
 - 8.1: Plug (Order-nr. 07182000)
 - 8.2: Eccentric rod (Order-nr. 07052000)
 - 9: Flexible connection hose (Order-nr. 45704000)
 - 10: Coupling nut 1/2" x 14.5 mm (Order-nr. 1290200M)*
 - 11: Eccentric rod (Order-nr. 07341000)*
- * Optional accessories