

20 405 001 **COSTA S PILLAR TAP**

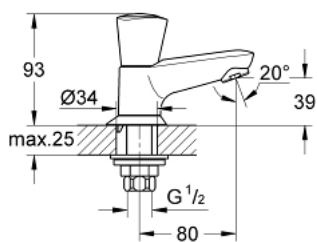

**PRODUCT DESCRIPTION**

- Colour: chrome
- metal handle
- heat-insulated
- screwable
- marking: blue
- Carbodur headpart
- cast spout with mousseur
- union nut 1/2" x 10,5 mm
- GROHE Long-Life finish



## 20 405 001 **COSTA S PILLAR TAP**

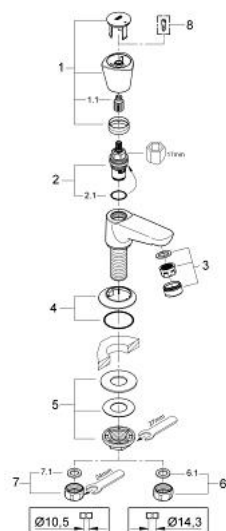

### **SPARE PARTS**, June 2007 – now

1: Handle (Order-nr. 45995000)

1.1: Repl. kit f.handle fastening (Order-nr. 0538600M)

2: Ceramic headpart, 1/2" (Order-nr. 45346000)

2.1: O-ring  $\varnothing 18.2 \times \varnothing 1.7$  (Order-nr. 0392400M)

3: Mousseur (Order-nr. 13929000)

4: Escutcheon (Order-nr. 45996000)

5: Shank fastening assembly (Order-nr. 45000000)

6: Coupling nut 1/2" x 14.5 mm (Order-nr. 1290200M)

6.1: Fibre seal dia. 12x2 mm (Order-nr. 0138900M)

7: Coupling nut 1/2" x 10.5 mm (Order-nr. 1290100M)

7.1: Fibre seal dia. 12x2 mm (Order-nr. 0138900M)

8: Screw for Costa/Avina products (Order-nr. 48013000)\*

\* Optional accessories