

20 601 000 **FLORIDA PILLAR TAP 1/2"**

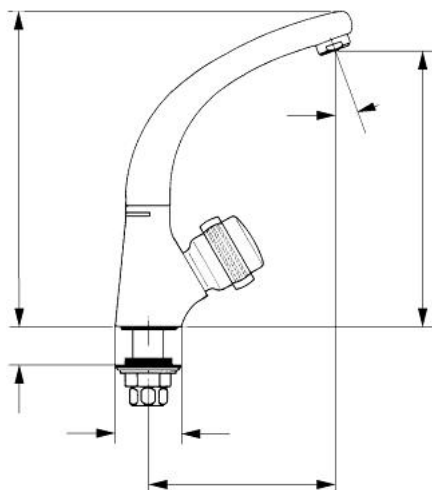

**PRODUCT DESCRIPTION**

- Colour: chrome
- Carbodur ceramic headparts 1/2", 180°
- swivel cast spout with mousseur and lockable stop limiter
- pop-up waste set 1 1/4"
- without handle
- GROHE Long-Life finish

## 20 601 000 FLORIDA PILLAR TAP 1/2"

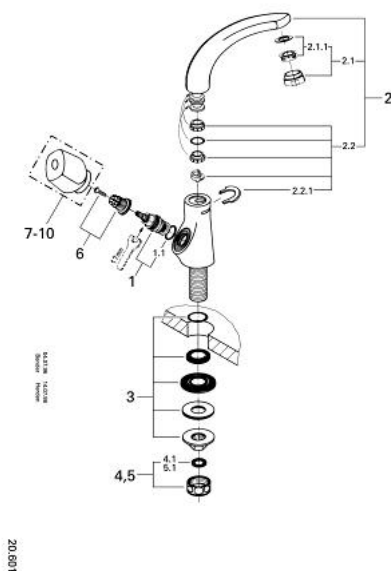

### SPARE PARTS, 1月 1985 – now

- 1: Ceramic headpart 1/2" (Order-nr. 45346000)
  - 1.1: O-ring Ø 18.2 x Ø 1.7 (Order-nr. 0392400M)
  - 2: Cast swivel spout (Order-nr. 13428000)
  - 2.1: Mousseur (Order-nr. 13929000)
  - 2.1.1: Replacement flow control M22x1 and M24x1 (Order-nr. 45002000)
  - 2.2: Spout connection set (Order-nr. 45474000)
  - 2.2.1: Safety disc (Order-nr. 0585000M)
  - 3: Shank fastening assembly 1/2" (Order-nr. 45000000)
  - 4: Coupling nut 1/2" (Order-nr. 1290100M)
  - 4.1: Fibre seal Ø 18,5 x Ø 12 x 2 (Order-nr. 0138900M)
  - 5: Coupling nut 1/2" x 14.5 mm (Order-nr. 1290200M)
  - 5.1: Fibre seal Ø 18,5 x Ø 12 x 2 (Order-nr. 0138900M)
  - 6: Replacement handle connection kit (Order-nr. 45186000)
  - 6.1: O-ring Ø 18.2 x Ø 1.7 (Order-nr. 0392400M)
  - 7: Handle (Order-nr. 45180000)\*
  - 8: Florida handle 115 (Order-nr. 45230000)\*
  - 9: Florida handle (500) (Order-nr. 45206000)\*
  - 10: Dorina handle (510) (Order-nr. 45207000)\*
- \* Optional accessories