

## 20 800 EN0 SEABURY 3-HOLE BASIN MIXER



### PRODUCT DESCRIPTION

- Colour: brushed nickel
- without handles
- cast spout with mousseur
- ceramic headparts 1/2", 90°
- pop-up waste set 1 1/4"
- pressure-proof, flexible connection hoses between spout and side valves
- for Seabury cross and lever handles 18 731 / 18 732
- GROHE LongLife finish

## 20 800 EN0 SEABURY 3-HOLE BASIN MIXER

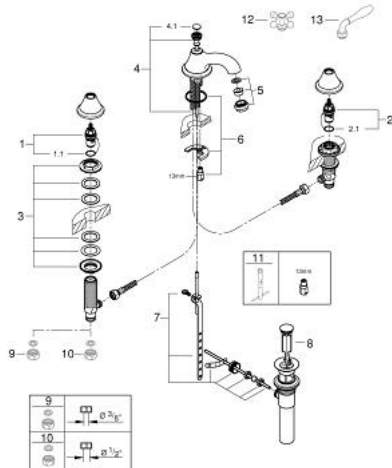

### SPARE PARTS, July 2016 – now

- 1: Ceramic headpart, 1/2" (Spare part-nr. 45882000)
  - 1.1: O-ring  $\varnothing 18.2 \times \varnothing 1.7$  (Spare part-nr. 0392400M)
  - 2: Ceramic headpart, 1/2" (Spare part-nr. 45883000)
  - 2.1: O-ring  $\varnothing 18.2 \times \varnothing 1.7$  (Spare part-nr. 0392400M)
  - 3: Shank fastening assembly (Spare part-nr. 45025000)
  - 4: Pop-up rod (Spare part-nr. 45766EN0)
  - 5: Flow straightener (Spare part-nr. 13931EN0)
  - 6: Shank mounting kit (Spare part-nr. 46249000)
  - 7: Ball rod (Spare part-nr. 48332000)
  - 9: Coupling nut 1/2" x 10.5 mm (Spare part-nr. 1290100M)\*
  - 10: Coupling nut 1/2" x 14.5 mm (Spare part-nr. 1290200M)\*
  - 11: Mounting wrench (Spare part-nr. 19017000)\*
  - 12: Sinfonia cross handles (Spare part-nr. 18731EN0)\*
  - 13: Lever Handle (Spare part-nr. 18732EN0)\*
- \* Optional accessories