

## 20 801 ZB0 GENEVA 3-HOLE BASIN MIXER



### PRODUCT DESCRIPTION

- Colour: antique bronze
- without handles
- high fixed cast spout with Mousseur
- ceramic headparts 1/2", 90°
- pop-up waste set 1 1/4"
- union nut with 10.5 mm drilling
- pressure-proof, flexible connection hoses between spout and side valves
- for Geneva cross and lever handles 18 733 / 18 734
- GROHE LongLife finish

## 20 801 ZB0 GENEVA 3-HOLE BASIN MIXER

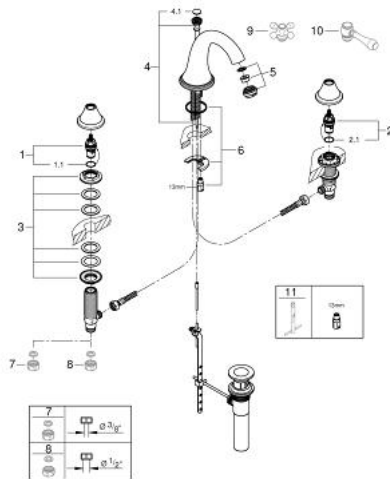

### SPARE PARTS, July 2016 – now

- 1: Ceramic headpart, 1/2" (Spare part-nr. 45882000)
- 1.1: O-ring  $\varnothing 18.2 \times \varnothing 1.7$  (Spare part-nr. 0392400M)
- 2: Ceramic headpart, 1/2" (Spare part-nr. 45883000)
- 2.1: O-ring  $\varnothing 18.2 \times \varnothing 1.7$  (Spare part-nr. 0392400M)
- 3: Shank fastening assembly (Spare part-nr. 45025000)
- 4: Pop-up rod (Spare part-nr. 45791ZB0)
- 4.10: Marking piece (Spare part-nr. 45763L00)
- 5: Flow straightener (Spare part-nr. 13931ZB0)
- 6: Shank mounting kit (Spare part-nr. 46249000)
- 7: Ball rod (Spare part-nr. 48332000)
- 9: Coupling nut 1/2" x 10.5 mm (Spare part-nr. 1290100M)\*
- 10: Coupling nut 1/2" x 14.5 mm (Spare part-nr. 1290200M)\*
- 11: Mounting wrench (Spare part-nr. 19017000)\*
- 12: Sinfonia cross handles (Spare part-nr. 18733ZB0)\*
- 13: Lever Handle (Spare part-nr. 18734ZB0)\*

\* Optional accessories