

## 20 892 000 TALIA 3-HOLE BASIN MIXER

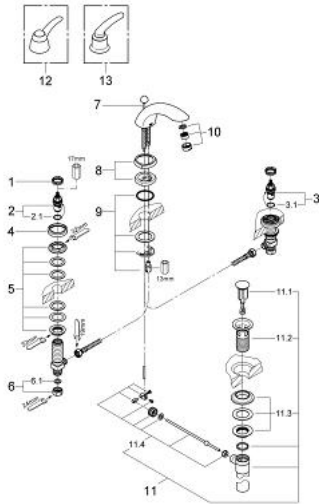

### SPARE PARTS, August 2009 – now

- 1: Ring (Spare part-nr. 03070000)
- 2: Ceramic headpart, 1/2" (Spare part-nr. 45882000)
- 2.1: O-ring  $\varnothing 18.2 \times \varnothing 1.7$  (Spare part-nr. 0392400M)
- 3: Ceramic headpart, 1/2" (Spare part-nr. 45883000)
- 3.1: O-ring  $\varnothing 18.2 \times \varnothing 1.7$  (Spare part-nr. 0392400M)
- 4: Escutcheon (Spare part-nr. 45822000)
- 5: Shank fastening assembly (Spare part-nr. 45025000)
- 6: Coupling nut 1/2" x 14.5 mm (Spare part-nr. 1290200M)
- 6.1: Fibre seal dia. 12x2 mm (Spare part-nr. 0138900M)
- 7: Pop-up rod (Spare part-nr. 45823000)
- 8: Escutcheon (Spare part-nr. 45825000)
- 9: Shank mounting kit (Spare part-nr. 46249000)
- 10: Flow straightener (Spare part-nr. 13955000)
- 11: Pop-up waste set (Spare part-nr. 28957000)
- 11.1: Plug (Spare part-nr. 45324000)
- 11.2: Housing (Spare part-nr. 01153000)
- 11.3: Ball rod (Spare part-nr. 45264000)
- 12: Talia lever handle (Spare part-nr. 18077000)\*
- 13: Talia metal handle, pair (Spare part-nr. 18085000)\*

\* Optional accessories

## 20 892 000 TALIA 3-HOLE BASIN MIXER

No exploded view is available for this spare part list.

### **SPARE PARTS**, January 2007 – August 2009

- 1: Ring (Spare part-nr. 03070000)
- 2: Ceramic headpart, 1/2" (Spare part-nr. 45882000)
- 3: Ceramic headpart, 1/2" (Spare part-nr. 45883000)
- 4: Escutcheon (Spare part-nr. 45822000)
- 5: Shank fastening assembly (Spare part-nr. 45025000)
- 6: Coupling nut 1/2" x 14.5 mm (Spare part-nr. 1290200M)
- 6.1: Fibre seal dia. 12x2 mm (Spare part-nr. 0138900M)
- 7: Pop-up rod (Spare part-nr. 45823000)
- 8: Escutcheon (Spare part-nr. 45825000)
- 9: Shank mounting kit (Spare part-nr. 46122000)
- 10: Flow straightener (Spare part-nr. 13955000)
- 11: Connection hose (Spare part-nr. 46322000)
- 12: Pop-up waste set (Spare part-nr. 28957000)
- 12.1: Plug (Spare part-nr. 45324000)
- 12.2: Housing (Spare part-nr. 01153000)
- 12.3: Mounting set (Spare part-nr. 45266000)
- 12.4: Ball rod (Spare part-nr. 45264000)
- 13: Talia lever handle (Spare part-nr. 18077000)\*
- 14: Talia metal handle, pair (Spare part-nr. 18085000)\*

\* Optional accessories

## 20 892 000 TALIA 3-HOLE BASIN MIXER

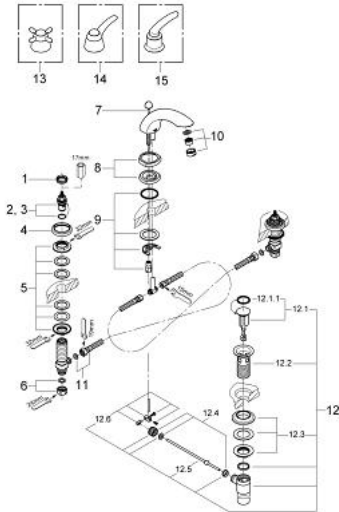

### SPARE PARTS, May 2005 – January 2007

- 1: Ring (Spare part-nr. 03070000)
  - 2: Ceramic headpart, 1/2" (Spare part-nr. 45882000)
  - 3: Ceramic headpart, 1/2" (Spare part-nr. 45883000)
  - 4: Escutcheon (Spare part-nr. 45822000)
  - 5: Shank fastening assembly (Spare part-nr. 45025000)
  - 6: Coupling nut 1/2" x 14.5 mm (Spare part-nr. 1290200M)
  - 7: Pop-up rod (Spare part-nr. 45823000)
  - 8: Escutcheon (Spare part-nr. 45825000)
  - 9: Shank mounting kit (Spare part-nr. 46122000)
  - 10: Flow straightener (Spare part-nr. 13955000)
  - 11: Flexible hose (Spare part-nr. 45442000)
  - 12: Pop-up waste set (Spare part-nr. 28957000)
  - 12.1: Plug (Spare part-nr. 45324000)
  - 12.1.1: Seat washer (Spare part-nr. 01147000)
  - 12.2: Housing (Spare part-nr. 01153000)
  - 12.3: Mounting set (Spare part-nr. 45266000)
  - 12.4: Nut and bushings (Spare part-nr. 45265000)
  - 12.5: Ball rod (Spare part-nr. 45264000)
  - 12.6: Joint piece (Spare part-nr. 45485000)
  - 13: Sinfonia cross handles (Spare part-nr. 18076000)\*
  - 14: Talia lever handle (Spare part-nr. 18077000)\*
  - 15: Talia metal handle, pair (Spare part-nr. 18085000)\*
- \* Optional accessories

## 20 892 000 TALIA 3-HOLE BASIN MIXER

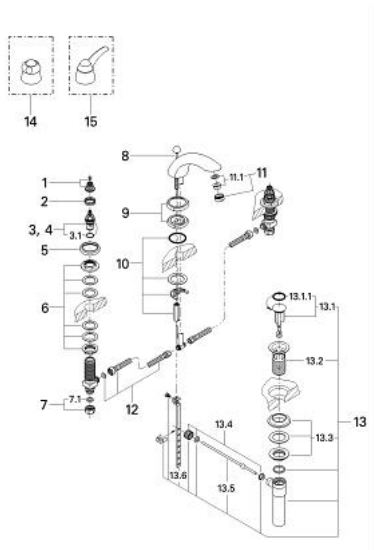

### SPARE PARTS, January 1994 – May 2005

- 1: Replacement handle connection kit (Spare part-nr. 45186000)
- 2: Ring (Spare part-nr. 03070000)
- 3: Ceramic headpart, 1/2" (Spare part-nr. 45882000)
- 3.1: O-ring  $\varnothing 18.2 \times \varnothing 1.7$  (Spare part-nr. 0392400M)
- 4: Ceramic headpart, 1/2" (Spare part-nr. 45883000)
- 4.1: O-ring  $\varnothing 18.2 \times \varnothing 1.7$  (Spare part-nr. 0392400M)
- 5: Escutcheon (Spare part-nr. 45822000)
- 6: Shank fastening assembly (Spare part-nr. 45025000)
- 7: Coupling nut 1/2" x 14.5 mm (Spare part-nr. 1290200M)
- 7.1: Fibre seal dia. 12x2 mm (Spare part-nr. 0138900M)
- 8: Pop-up rod (Spare part-nr. 45823000)
- 9: Escutcheon (Spare part-nr. 45825000)
- 10: Shank mounting kit (Spare part-nr. 46122000)
- 11: Flow straightener (Spare part-nr. 13955000)
- 11.1: Strainer (Spare part-nr. 45220000)
- 12: Flexible hose (Spare part-nr. 45442000)
- 13: Pop-up waste set (Spare part-nr. 28957000)
- 13.1: Plug (Spare part-nr. 45324000)
- 13.1.1: Seat washer (Spare part-nr. 01147000)
- 13.2: Housing (Spare part-nr. 01153000)
- 13.3: Mounting set (Spare part-nr. 45266000)
- 13.4: Nut and bushings (Spare part-nr. 45265000)
- 13.5: Ball rod (Spare part-nr. 45264000)
- 13.6: Joint piece (Spare part-nr. 45485000)
- 14: Handle (Spare part-nr. 45818000)\*
- 15: Lever (Spare part-nr. 45820000)\*

\* Optional accessories