

22 917 000 ATLANTA ANGLE VALVE 1/2"

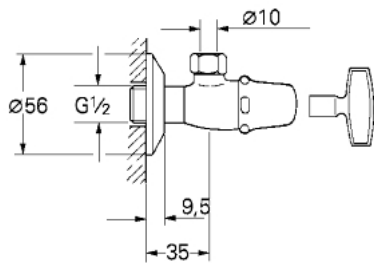

PRODUCT DESCRIPTION

- Colour: chrome
- wall connection 1/2"
- outlet 3/8"
- socket spanner headpart
- closed cap
- with compression nut Ø 10 mm
- marking: neutral
- sliding escutcheon
- GROHE LongLife finish

22 917 000 ATLANTA ANGLE VALVE 1/2"

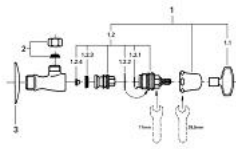

SPARE PARTS, 4月 2008 – now

- 1: Headpart 1/2" (Spare part-nr. 11148000)
- 1.1: Socket spanner 1/2" (Spare part-nr. 02277000)
- 1.2: Headpart 1/2" (Spare part-nr. 07146000)
- 1.2.1: Sealing washer $\varnothing 6 \times \varnothing 2$ (Spare part-nr. 0128300M)
- 1.2.2: O-ring $\varnothing 18.2 \times \varnothing 1.7$ (Spare part-nr. 0392400M)
- 1.2.3: Seal (Spare part-nr. 0529100M)
- 2: Compression union 3/8" (Spare part-nr. 1291400M)
- 3: Escutcheon 1/2" (Spare part-nr. 02201000)