

## 23 137 000 EUROCUBE PILLAR TAP XS-SIZE

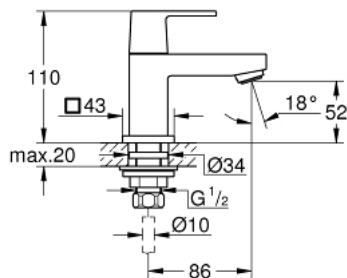

### PRODUCT DESCRIPTION

- Colour: chrome
- single hole installation
- metal lever
- ceramic headpart 1/2", 90°
- GROHE LongLife finish
- GROHE EcoJoy - Less water, perfect flow
- maximum flow rate (at 3 bar): 5 l/min
- SpeedClean mousseur
- union nut 1/2" x 10.5 mm



## 23 137 000 EUROCUBE PILLAR TAP XS-SIZE

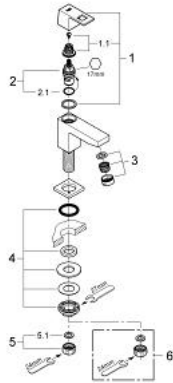

### SPARE PARTS, 9月 2011 – now

- 1: Eurocube lever (Spare part-nr. 48127000)
- 1.10: Replacement handle connection kit (Spare part-nr. 45186000)
- 1.10.1: O-ring  $\varnothing$  18.2 x  $\varnothing$  1.7 (Spare part-nr. 0392400M)
- 2: Ceramic headpart 1/2" (Spare part-nr. 45882000)
- 2.1: O-ring  $\varnothing$  18.2 x  $\varnothing$  1.7 (Spare part-nr. 0392400M)
- 3: Laminar flow straightener (Spare part-nr. 13955000)
- 4: Shank fastening assembly 1/2" (Spare part-nr. 45000000)
- 5: Coupling nut 1/2" (Spare part-nr. 1290100M)
- 5.1: Fibre seal  $\varnothing$  18,5 x  $\varnothing$  12 x 2 (Spare part-nr. 0138900M)
- 6: Coupling nut 1/2" x 14.5 mm (Spare part-nr. 1290200M)\*

\* Optional accessories