

24 019 000 **GENEVA 3-HOLE BIDET MIXER**



PRODUCT DESCRIPTION

- Colour: chrome
- without handles
- rim flush/bidet spray
- with anti-vacuum device
- pressure-proof, flexible connection hoses
- for Geneva cross and lever handles 18 733 / 18 734
- GROHE Long-Life finish

24 019 000 GENEVA 3-HOLE BIDET MIXER

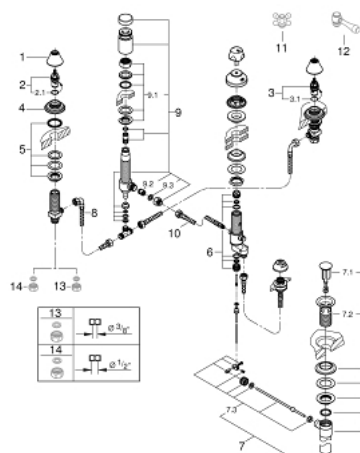

SPARE PARTS, August 2016 – now

- 1: Shield (Order-nr. 45907000)
 - 2: Ceramic headpart, 1/2" (Order-nr. 45882000)
 - 2.1: O-ring $\varnothing 18.2 \times \varnothing 1.7$ (Order-nr. 0392400M)
 - 3: Ceramic headpart, 1/2" (Order-nr. 45883000)
 - 3.1: O-ring $\varnothing 18.2 \times \varnothing 1.7$ (Order-nr. 0392400M)
 - 4: Escutcheon (Order-nr. 45906000)
 - 5: Shank fastening assembly (Order-nr. 45025000)
 - 6: Repl. kit f. seal (Order-nr. 45027000)
 - 7: Pop-up waste set (Order-nr. 28957000)
 - 7.1: Plug (Order-nr. 45324000)
 - 7.2: Housing (Order-nr. 01153000)
 - 7.3: Ball rod (Order-nr. 45264000)
 - 8: Flexible connection hose (Order-nr. 45704000)
 - 9: Vacuum Breaker (Order-nr. 45852000)
 - 9.1: Shank mounting kit (Order-nr. 45855000)
 - 9.2: Non-return valve (Order-nr. 08565000)
 - 9.3: Fibre seal dia. 12x2 mm (Order-nr. 0138900M)
 - 10: Flexible connector M10x1xM15x1x350 (Order-nr. 46254000)
 - 11: Sinfonia cross handles (Order-nr. 18733000)*
 - 12: Lever Handle (Order-nr. 18734000)*
 - 13: Coupling nut 1/2" x 10.5 mm (Order-nr. 1290100M)*
 - 14: Coupling nut 1/2" x 14.5 mm (Order-nr. 1290200M)*
- * Optional accessories