

24 019 BE0 **GENEVA THREE-HOLE BIDET MIXER**



PRODUCT DESCRIPTION

- Colour: polished nickel
- without handles
- rim flush/bidet spray
- with anti-vacuum device
- pressure-proof, flexible connection hoses
- for Geneva cross and lever handles 18 733 / 18 734
- GROHE Long-Life finish

24 019 BE0 GENEVA THREE-HOLE BIDET MIXER

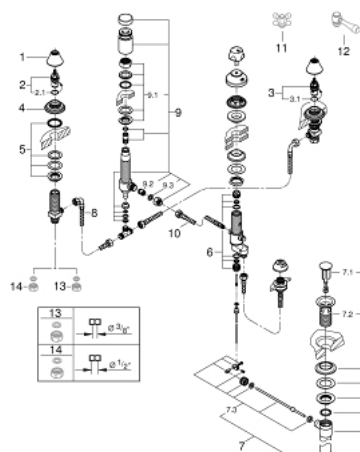

SPARE PARTS, 8月 2016 – now

- 1: Cap (Order-nr. 45907BE0)
- 2: Ceramic headpart 1/2" (Order-nr. 45882000)
- 2.1: O-ring Ø 18.2 x Ø 1.7 (Order-nr. 0392400M)
- 3: Ceramic headpart 1/2" (Order-nr. 45883000)
- 3.1: O-ring Ø 18.2 x Ø 1.7 (Order-nr. 0392400M)
- 4: Escutcheon (Order-nr. 45906BE0)
- 5: Counter screws M28 x 1.5 (Order-nr. 45025000)
- 6: Seal kit (Order-nr. 45027000)
- 7: Waste fitting (Order-nr. 28957BE0)
- 7.1: Plug (Order-nr. 45324BE0)
- 7.2: Housing (Order-nr. 01153BE0)
- 7.3: Ball rod (Order-nr. 45264000)
- 8: Flexible connection hose (Order-nr. 45704000)
- 9: Vacuum breaker (Order-nr. 45852BE0)
- 9.1: Shank mounting kit (Order-nr. 45855000)
- 9.2: Non-return valve (Order-nr. 08565000)
- 9.3: Fibre seal Ø 18,5 x Ø 12 x 2 (Order-nr. 0138900M)
- 10: Flexible connector M10 x 1 x M15 x 1 x 350 (Order-nr. 46254000)
- 11: Cross handle (Order-nr. 18733BE0)*
- 12: Lever handle (Order-nr. 18734BE0)*
- 13: Coupling nut 1/2" (Order-nr. 1290100M)*
- 14: Coupling nut 1/2" x 14.5 mm (Order-nr. 1290200M)*

* Optional accessories