

## 24 019 ZB0 **GENEVA 3-HOLE BIDET MIXER**



### **PRODUCT DESCRIPTION**

- Colour: antique bronze
- without handles
- rim flush/bidet spray
- with anti-vacuum device
- pressure-proof, flexible connection hoses
- for Geneva cross and lever handles 18 733 / 18 734
- GROHE Long-Life finish

## 24 019 ZB0 GENEVA 3-HOLE BIDET MIXER

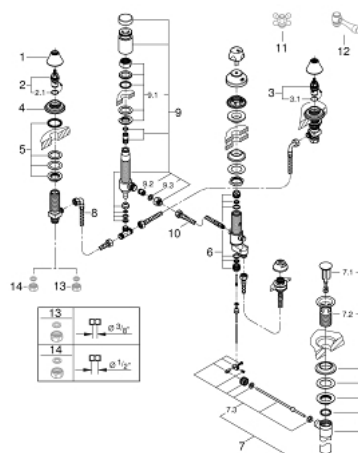

### SPARE PARTS, August 2016 – now

- 1: Shield (Order-nr. 45907ZB0)
  - 2: Ceramic headpart, 1/2" (Order-nr. 45882000)
  - 2.1: O-ring  $\varnothing 18.2 \times \varnothing 1.7$  (Order-nr. 0392400M)
  - 3: Ceramic headpart, 1/2" (Order-nr. 45883000)
  - 3.1: O-ring  $\varnothing 18.2 \times \varnothing 1.7$  (Order-nr. 0392400M)
  - 4: Escutcheon (Order-nr. 45906ZB0)
  - 5: Shank fastening assembly (Order-nr. 45025000)
  - 6: Repl. kit f. seal (Order-nr. 45027000)
  - 7: Pop-up waste set (Order-nr. 28957ZB0)
  - 7.1: Plug (Order-nr. 45324ZB0)
  - 7.2: Housing (Order-nr. 01153ZB0)
  - 7.3: Ball rod (Order-nr. 45264000)
  - 8: Flexible connection hose (Order-nr. 45704000)
  - 9: Vacuum Breaker (Order-nr. 45852ZB0)
  - 9.1: Shank mounting kit (Order-nr. 45855000)
  - 9.2: Non-return valve (Order-nr. 08565000)
  - 9.3: Fibre seal dia. 12x2 mm (Order-nr. 0138900M)
  - 10: Flexible connector M10x1xM15x1x350 (Order-nr. 46254000)
  - 11: Sinfonia cross handles (Order-nr. 18733ZB0)\*
  - 12: Lever Handle (Order-nr. 18734ZB0)\*
  - 13: Coupling nut 1/2" x 10.5 mm (Order-nr. 1290100M)\*
  - 14: Coupling nut 1/2" x 14.5 mm (Order-nr. 1290200M)\*
- \* Optional accessories