

## 24 020 000 **SEABURY 3-HOLE BIDET MIXER**



### **PRODUCT DESCRIPTION**

- Colour: chrome
- without handles
- rim flush/bidet spray
- with anti-vacuum device
- pressure-proof, flexible connection hoses
- for Seabury cross and lever handles 18 731 / 18 732
- GROHE Long-Life finish

## 24 020 000 SEABURY 3-HOLE BIDET MIXER

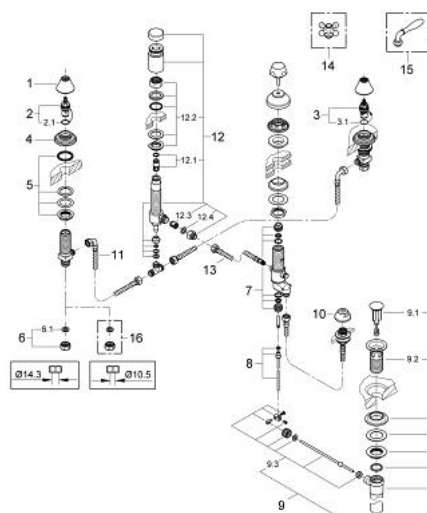

### SPARE PARTS, December 2013 – now

- 1: Shield (Order-nr. 45907000)
- 2: Ceramic headpart, 1/2" (Order-nr. 45882000)
- 2.1: O-ring  $\varnothing 18.2 \times \varnothing 1.7$  (Order-nr. 0392400M)
- 3: Ceramic headpart, 1/2" (Order-nr. 45883000)
- 3.1: O-ring  $\varnothing 18.2 \times \varnothing 1.7$  (Order-nr. 0392400M)
- 4: Escutcheon (Order-nr. 45906000)
- 5: Shank fastening assembly (Order-nr. 45025000)
- 6: Coupling nut 1/2" x 14.5 mm (Order-nr. 1290200M)
- 6.1: Fibre seal dia. 12x2 mm (Order-nr. 0138900M)
- 7: Repl. kit f. seal (Order-nr. 45027000)
- 8: Swivel vertical pop-up rod (Order-nr. 45646000)
- 9: Pop-up waste set (Order-nr. 28957000)
- 9.1: Plug (Order-nr. 45324000)
- 9.2: Housing (Order-nr. 01153000)
- 9.3: Ball rod (Order-nr. 45264000)
- 10: Spray faceplate (Order-nr. 02664000)
- 11: Flexible connection hose (Order-nr. 45704000)
- 12: Vacuum Breaker (Order-nr. 45852000)
- 12.1: Shank mounting kit (Order-nr. 45855000)
- 12.2: Non-return valve (Order-nr. 08565000)
- 12.3: Fibre seal dia. 12x2 mm (Order-nr. 0138900M)
- 12.4: Flexible connector M10x1xM15x1x350 (Order-nr. 46254000)
- 14: Sinfonia cross handles (Order-nr. 18731000)\*
- 15: Lever Handle (Order-nr. 18732000)\*
- 16: Coupling nut 1/2" x 10.5 mm (Order-nr. 1290100M)\*

\* Optional accessories