

24 667 000 **TALIA 3-HOLE BIDET MIXER**



PRODUCT DESCRIPTION

- Colour: chrome
- GROHE Long-Life finish
- without handles
- Volo Handles 18 085 000 & 18 085 EN0 (sold separately)
- lever handles 18 077 000 & 18 077 EN0 (sold separately)

24 667 000 TALIA 3-HOLE BIDET MIXER

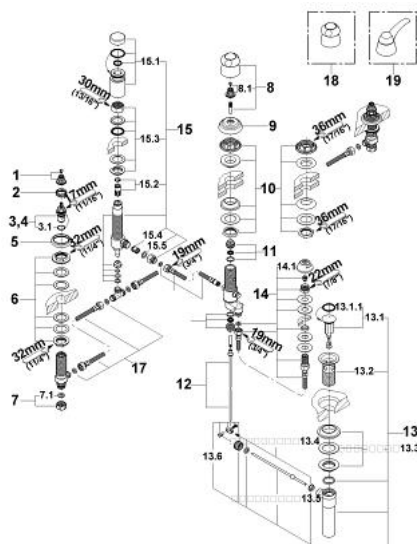

SPARE PARTS, January 1994 – now

- 1: Replacement handle connection kit (Order-nr. 45186000)
- 1.1: O-ring $\varnothing 18.2 \times \varnothing 1.7$ (Order-nr. 0392400M)
- 2: Ring (Order-nr. 03070000)
- 3: Ceramic headpart, 1/2" (Order-nr. 45882000)
- 3.1: O-ring $\varnothing 18.2 \times \varnothing 1.7$ (Order-nr. 0392400M)
- 4: Ceramic headpart, 1/2" (Order-nr. 45883000)
- 4.1: O-ring $\varnothing 18.2 \times \varnothing 1.7$ (Order-nr. 0392400M)
- 5: Escutcheon (Order-nr. 45822000)
- 6: Shank fastening assembly (Order-nr. 45025000)
- 7: Coupling nut 1/2" x 14.5 mm (Order-nr. 1290200M)
- 7.1: Fibre seal dia. 12x2 mm (Order-nr. 0138900M)
- 8: Repl.kit f.diverter handle (Order-nr. 45799000)
- 8.1: Replacement handle connection kit (Order-nr. 45186000)
- 9: Escutcheon (Order-nr. 02281000)
- 10: Screw connection for bidet body (Order-nr. 45026000)
- 11: Repl. kit f. seal (Order-nr. 45027000)
- 12: Jointed rod (Order-nr. 06085000)
- 13: Pop-up waste set (Order-nr. 28957000)
- 13.1: Plug (Order-nr. 45324000)
- 13.2: Housing (Order-nr. 01153000)
- 13.3: Ball rod (Order-nr. 45264000)
- 14: Rim spray (Order-nr. 24210000)
- 14.1: Spray faceplate (Order-nr. 02664000)
- 15: Vacuum Breaker (Order-nr. 45852000)
- 15.1: Shank mounting kit (Order-nr. 45855000)
- 15.2: Non-return valve (Order-nr. 08565000)
- 15.3: Fibre seal dia. 12x2 mm (Order-nr. 0138900M)
- 16: Connection hose (Order-nr. 46255000)
- 17: Flexible connection hose (Order-nr. 45704000)
- 18: Handle (Order-nr. 45818000)*
- 19: Lever (Order-nr. 45820000)*
- * Optional accessories