

## 24 667 000 **TALIA THREE-HOLE BIDET MIXER**



### **PRODUCT DESCRIPTION**

- Colour: chrome
- GROHE Long-Life finish
- without handles
- Volo Handles 18 085 000 & 18 085 EN0 (sold separately)
- lever handles 18 077 000 & 18 077 EN0 (sold separately)

## 24 667 000 TALIA THREE-HOLE BIDET MIXER

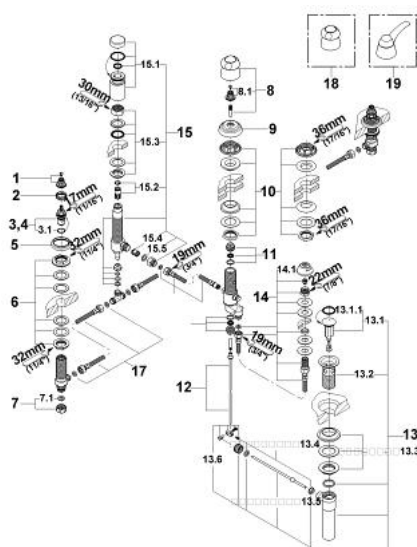

### SPARE PARTS, 1月 1994 – now

1: Replacement handle connection kit (Order-nr. 45186000)

1.1: O-ring Ø 18.2 x Ø 1.7 (Order-nr. 0392400M)

2: Support ring (Order-nr. 03070000)

3: Ceramic headpart 1/2" (Order-nr. 45882000)

3.1: O-ring Ø 18.2 x Ø 1.7 (Order-nr. 0392400M)

4: Ceramic headpart 1/2" (Order-nr. 45883000)

4.1: O-ring Ø 18.2 x Ø 1.7 (Order-nr. 0392400M)

5: Escutcheon (Order-nr. 45822000)

6: Counter screws M28 x 1.5 (Order-nr. 45025000)

7: Coupling nut 1/2" x 14.5 mm (Order-nr. 1290200M)

7.1: Fibre seal Ø 18,5 x Ø 12 x 2 (Order-nr. 0138900M)

8: Diverter handle (Order-nr. 45799000)

8.1: Replacement handle connection kit (Order-nr. 45186000)

9: Escutcheon (Order-nr. 02281000)

10: Screw connection M30 x 1.5 (Order-nr. 45026000)

11: Seal kit (Order-nr. 45027000)

12: Joint rod (Order-nr. 06085000)

13: Waste fitting (Order-nr. 28957000)

13.1: Plug (Order-nr. 45324000)

13.2: Housing (Order-nr. 01153000)

13.3: Ball rod (Order-nr. 45264000)

14: Rim spray (Order-nr. 24210000)

14.1: Spray faceplate (Order-nr. 02664000)

15: Vacuum breaker (Order-nr. 45852000)

15.1: Shank mounting kit (Order-nr. 45855000)

15.2: Non-return valve (Order-nr. 08565000)

15.3: Fibre seal Ø 18,5 x Ø 12 x 2 (Order-nr. 0138900M)

16: Connection hose (Order-nr. 46255000)

17: Flexible connection hose (Order-nr. 45704000)

18: Handle (Order-nr. 45818000)\*

19: Lever (Order-nr. 45820000)\*

\* Optional accessories