

25 007 000 **SENTOSA BATH MIXER 1/2"**

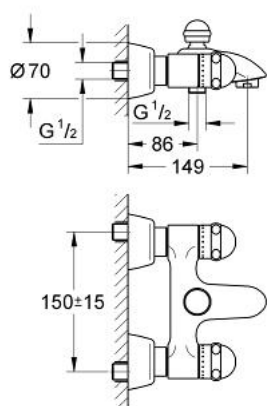

**PRODUCT DESCRIPTION**

- Colour: chrome
- wall mounted
- Carbodur ceramic headparts 1/2", 180°
- automatic diverter: bath/shower
- mousseur
- shower outlet 1/2"
- integrated non-return valve
- S-unions
- GROHE Long-Life finish

## 25 007 000 SENTOSA BATH MIXER 1/2"

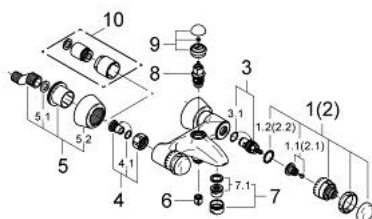

### SPARE PARTS, 12月 2004 – now

- 1: Handle 1/2" (Sentosa) (Order-nr. 45538IP0)
  - 1.1: Replacement handle connection kit (Order-nr. 45186000)
    - 1.1.1: O-ring Ø 18.2 x Ø 1.7 (Order-nr. 0392400M)
    - 1.2: Guide ring (Order-nr. 0202100M)
  - 2: Handle 1/2", red (Sentosa) (Order-nr. 45539IP0)
    - 2.1: Replacement handle connection kit (Order-nr. 45186000)
    - 2.2: Guide ring (Order-nr. 0202100M)
  - 3: Ceramic headpart 1/2" (Order-nr. 45346000)
    - 3.1: O-ring Ø 18.2 x Ø 1.7 (Order-nr. 0392400M)
  - 4: Screw connection (Order-nr. 45544000)
    - 4.1: Seal Ø 15 x Ø 2 (Order-nr. 0311900M)
  - 5: S-union (Order-nr. 12058000)
    - 5.1: Seal (Order-nr. 0138600M)
    - 5.2: Covering escutcheon (Order-nr. 45545000)
  - 6: Non-return valve (Order-nr. 08565000)
  - 7: Mousseur (Order-nr. 13927000)
    - 7.1: Replacement flow control M28x1 (Order-nr. 45029000)
  - 8: Diverter (Order-nr. 08915000)
  - 9: Diverter knob (Order-nr. 45547IP0)
  - 10: Extension set, 30 mm (Order-nr. 46238000)\*
- \* Optional accessories