

25 054 000 GENEVA 3-HOLE BATH/SOWER COMBINATION

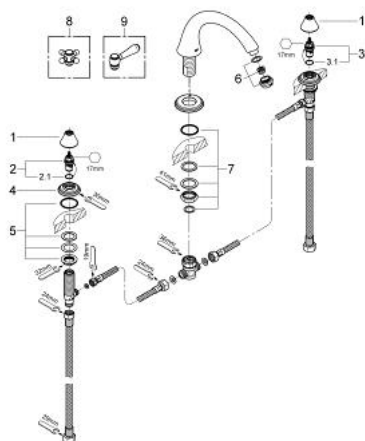

SPARE PARTS, August 2012 – now

- 1: Shield (Spare part-nr. 45907000)
- 2: Ceramic headpart, 1/2" (Spare part-nr. 45882000)
- 2.1: O-ring $\varnothing 18.2 \times \varnothing 1.7$ (Spare part-nr. 0392400M)
- 3: Ceramic headpart, 1/2" (Spare part-nr. 45883000)
- 3.1: O-ring $\varnothing 18.2 \times \varnothing 1.7$ (Spare part-nr. 0392400M)
- 4: Escutcheon (Spare part-nr. 45906000)
- 5: Shank fastening assembly (Spare part-nr. 45025000)
- 6: Sistra (Spare part-nr. 13934000)
- 7: Shank mounting kit (Spare part-nr. 46078000)
- 8: Sinfonia cross handles (Spare part-nr. 18733000)*
- 9: Lever Handle (Spare part-nr. 18734000)*

* Optional accessories

25 054 000 GENEVA 3-HOLE BATH/SHOWER COMBINATION

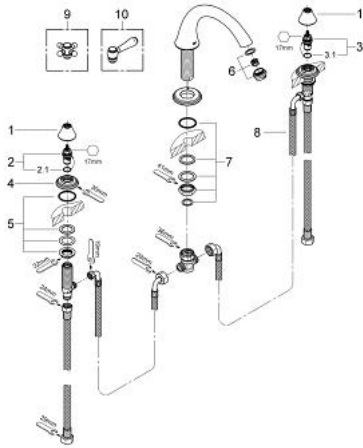

SPARE PARTS, May 2009 – August 2012

- 1: Shield (Spare part-nr. 45907000)
- 2: Ceramic headpart, 1/2" (Spare part-nr. 45882000)
- 2.1: O-ring $\varnothing 18.2 \times \varnothing 1.7$ (Spare part-nr. 0392400M)
- 3: Ceramic headpart, 1/2" (Spare part-nr. 45883000)
- 3.1: O-ring $\varnothing 18.2 \times \varnothing 1.7$ (Spare part-nr. 0392400M)
- 4: Escutcheon (Spare part-nr. 45906000)
- 5: Shank fastening assembly (Spare part-nr. 45025000)
- 6: Sistra (Spare part-nr. 13934000)
- 7: Shank mounting kit (Spare part-nr. 46078000)
- 8: Flexible hose (Spare part-nr. 03052000)
- 9: Sinfonia cross handles (Spare part-nr. 18733000)*
- 10: Lever Handle (Spare part-nr. 18734000)*

* Optional accessories

25 054 000 GENEVA 3-HOLE BATH/SHOWER COMBINATION

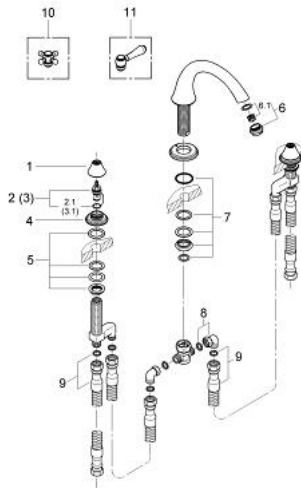

SPARE PARTS, January 2001 – May 2009

- 1: Shield (Spare part-nr. 45907000)
- 2: Ceramic headpart, 1/2" (Spare part-nr. 45882000)
- 2.1: O-ring $\varnothing 18.2 \times \varnothing 1.7$ (Spare part-nr. 0392400M)
- 3: Ceramic headpart, 1/2" (Spare part-nr. 45883000)
- 3.1: O-ring $\varnothing 18.2 \times \varnothing 1.7$ (Spare part-nr. 0392400M)
- 4: Escutcheon (Spare part-nr. 45906000)
- 5: Shank mounting kit (Spare part-nr. 45286000)
- 6: Sistra (Spare part-nr. 13934000)
- 6.1: Repl.kit f. Sistra M28x1 (Spare part-nr. 45047000)
- 7: Shank mounting kit (Spare part-nr. 45715000)
- 8: Elbow union (Spare part-nr. 12418000)
- 9: Connection hose (Spare part-nr. 07772000)
- 10: Sinfonia cross handles (Spare part-nr. 45776000)*
- 11: Lever Handle (Spare part-nr. 45790000)*

* Optional accessories

25 054 000 GENEVA 3-HOLE BATH/SHOWER COMBINATION

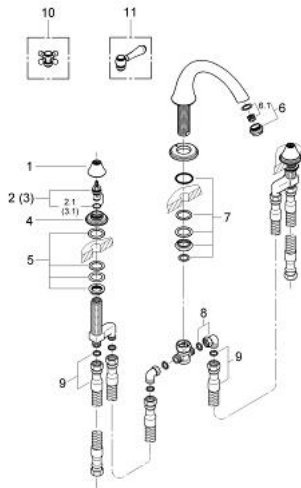

SPARE PARTS, January 2001 – January 2003

- 1: Shield (Spare part-nr. 45907000)
- 2: Ceramic headpart, 1/2" (Spare part-nr. 45882000)
- 2.1: O-ring $\varnothing 18.2 \times \varnothing 1.7$ (Spare part-nr. 0392400M)
- 3: Ceramic headpart, 1/2" (Spare part-nr. 45883000)
- 3.1: O-ring $\varnothing 18.2 \times \varnothing 1.7$ (Spare part-nr. 0392400M)
- 4: Escutcheon (Spare part-nr. 45906000)
- 5: Shank mounting kit (Spare part-nr. 45286000)
- 6: Sistra (Spare part-nr. 13934000)
- 6.1: Repl.kit f. Sistra M28x1 (Spare part-nr. 45047000)
- 7: Shank mounting kit (Spare part-nr. 45715000)
- 8: Elbow union (Spare part-nr. 12418000)
- 11: Sinfonia cross handles (Spare part-nr. 45776000)*
- 12: Lever Handle (Spare part-nr. 45790000)*

* Optional accessories