

25 074 EN0 **KENSINGTON 3-HOLE BATH COMBINATION**



PRODUCT DESCRIPTION

- Colour: brushed nickel
- without handles
- consists of:
 - diverter bath spout with mousseur
 - side valves
 - ceramic headparts 1/2", 90°
- GROHE Long-Life finish
- pressure-proof, flexible connection hoses between spout and side valves
- round handles 18 086 000 & 18 086 EN0 (sold separately)
- Swarovski crystal handles 18 086 VP0 (sold separately)
- lever handles 18 087 000 & 18 087 EN0 (sold separately)

25 074 EN0 KENSINGTON 3-HOLE BATH COMBINATION

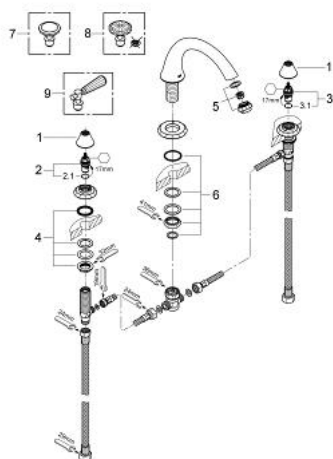

SPARE PARTS, August 2012 – now

- 1: Shield (Order-nr. 45907EN0)
- 2: Ceramic headpart, 1/2" (Order-nr. 45882000)
- 2.1: O-ring $\varnothing 18.2 \times \varnothing 1.7$ (Order-nr. 0392400M)
- 3: Ceramic headpart, 1/2" (Order-nr. 45883000)
- 3.1: O-ring $\varnothing 18.2 \times \varnothing 1.7$ (Order-nr. 0392400M)
- 4: Shank fastening assembly (Order-nr. 45025000)
- 5: Sistra (Order-nr. 13991EN0)
- 6: Shank mounting kit (Order-nr. 46078000)
- 7: Crystal handle (Order-nr. 18086EN0)*
- 8: Crystal handle (Order-nr. 18086VP0)*
- 9: Lever Handle (Order-nr. 18087EN0)*

* Optional accessories