

25 561 000 **TALIA BATH MIXER 1/2"**

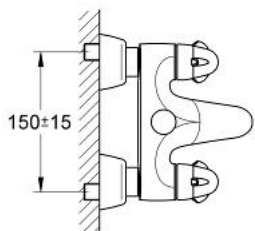
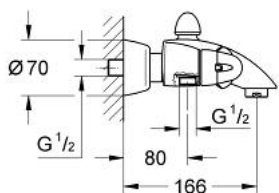

**PRODUCT DESCRIPTION**

- Colour: chrome
- wall mounted
- Carbodur ceramic headparts 1/2", 180°
- automatic diverter: bath/shower
- integrated non-return valves
- mousseur
- S-unions
- GROHE Long-Life finish

## 25 561 000 TALIA BATH MIXER 1/2"

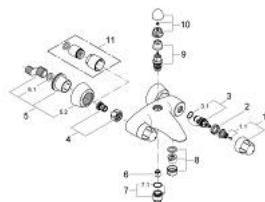

### SPARE PARTS, 7月 2007 – now

- 1: Handle (Order-nr. 45357IP0)
- 1.1: Replacement handle connection kit (Order-nr. 45186000)
  - 1.1.1: O-ring Ø 18.2 x Ø 1.7 (Order-nr. 0392400M)
- 2: Support ring (Order-nr. 03070000)
- 3: Ceramic headpart 1/2" (Order-nr. 45346000)
  - 3.1: O-ring Ø 18.2 x Ø 1.7 (Order-nr. 0392400M)
- 4: Screw connection (Order-nr. 45582000)
- 5: S-union (Order-nr. 12058000)
  - 5.1: Seal (Order-nr. 0138600M)
  - 5.2: Covering escutcheon (Order-nr. 45545000)
- 6: Non-return valve (Order-nr. 08565000)
- 7: Outlet nipple (Order-nr. 45546000)
  - 7.1: Sealing washer Ø 21 x Ø 2 (Order-nr. 0599900M)
- 8: Mousseur (Order-nr. 13927000)
- 9: Diverter (Order-nr. 08915000)
- 10: Diverter knob (Order-nr. 45547000)
- 11: Extension set, 30 mm (Order-nr. 46238000)\*

\* Optional accessories