

26 305 000 TEMPESTA COSMOPOLITAN SYSTEM 200 SHOWER SYSTEM WITH SINGLE LEVER BATH MIXER FOR WALL MOUNTING

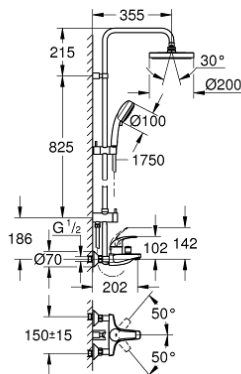

PRODUCT DESCRIPTION

- Colour: chrome
- consists of:
 - horizontal 355 mm shower arm
 - Exposed single-lever shower mixer with diverter
 - allows change between:
 - head shower Tempesta Cosmopolitan 200 (27 541)
 - spray pattern: Rain
 - with ball joint, rotation angle $\pm 20^\circ$
 - bath spout
 - separate diverter for hand shower
 - hand shower Tempesta Cosmopolitan 100 (27 573 001)
 - spray patterns: GROHE Rain O², Rain, Massage, Jet
 - adjustable in height with gliding element
 - Relaxaflex shower hose 1750 mm (28 154)
 - distance between single-lever mixer and upper bracket: 1011 mm
 - GROHE SilkMove 46 mm ceramic cartridge
 - GROHE DreamSpray - perfect spray pattern
 - GROHE SpeedClean - effortless limescale removal
 - suitable for instantaneous heaters (min. 19 kW/h)
 - minimum flow rate 7 l/min.
 - minimum pressure 1,0 bar



26 305 000 TEMPESTA COSMOPOLITAN SYSTEM 200 SHOWER SYSTEM WITH SINGLE LEVER BATH MIXER FOR WALL MOUNTING

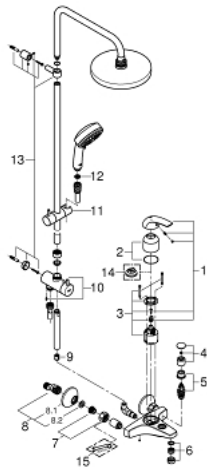

SPARE PARTS, October 2014 – now

- 1: Lever (Spare part-nr. 46700000)
- 2: Shield (Spare part-nr. 46578000)
- 3: Cartridge (Spare part-nr. 46048000)
- 4: Diverter knob (Spare part-nr. 46571000)
- 5: Diverter (Spare part-nr. 08915000)
- 6: Mousseur (Spare part-nr. 13952000)
- 7: Screw joint (Spare part-nr. 45044000)
- 8: S-union (Spare part-nr. 12075000)
- 8.1: Ball seal dia. 9x6.8 mm (Spare part-nr. 0138600M)
- 8.2: Escutcheon (Spare part-nr. 0221000M)
- 9: Non-return valve (Spare part-nr. 08565000)
- 10: Diverter (Spare part-nr. 46877000)
- 11: Sliding piece (Spare part-nr. 46876000)
- 12: Dirt strainer (Spare part-nr. 0700200M)
- 13: Mounting set (Spare part-nr. 46878000)
- 14: Temperature limiter (Spare part-nr. 46375000)*
- 15: Special spanner (Spare part-nr. 19377000)*

* Optional accessories