

26 792 001 **COSTA S MULTI-PURPOSE MIXER**

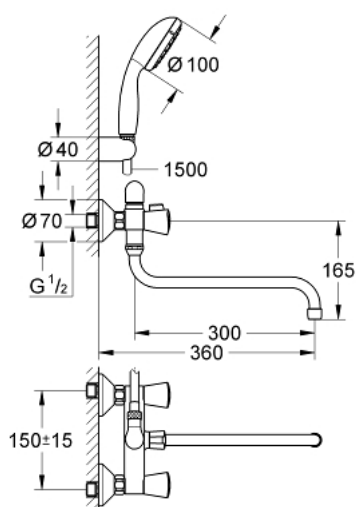

PRODUCT DESCRIPTION

- Colour: chrome
- wall mounted
- metal handles
- heat-insulated
- screwable
- Carbodur headpart
- automatic diverter: bath/shower
- S-unions
- connection angle 12 419 000
- spout 300 mm 13 017 000
- hand shower Tempesta 100, 1 spray, 9.5 l/min (27 923 000)
- Relaxaflex-hose 1500 mm 28 151
- wall shower holder 28 605
- GROHE Long-Life finish



26 792 001 **COSTA S MULTI-PURPOSE MIXER**

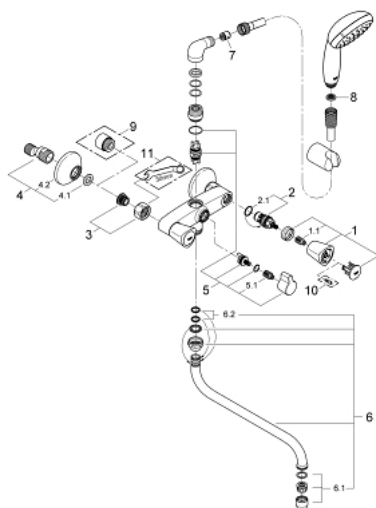

SPARE PARTS, October 2013 – now

- 1: Handle (Order-nr. 45995000)
- 1.1: Repl. kit f.handle fastening (Order-nr. 0538600M)
- 2: Ceramic headpart, 1/2" (Order-nr. 45346000)
- 2.1: O-ring $\varnothing 18.2 \times \varnothing 1.7$ (Order-nr. 0392400M)
- 3: Screw joint (Order-nr. 45044000)
- 4: S-union (Order-nr. 12075000)
- 4.1: Ball seal dia. 9x6.8 mm (Order-nr. 0138600M)
- 4.2: Escutcheon (Order-nr. 0221000M)
- 5: Repl.kit f.rotary valve (Order-nr. 48006000)
- 5.1: Repl. kit f.handle fastening (Order-nr. 0538600M)
- 6: Swivel tube spout (Order-nr. 13017000)
- 6.1: Mousseur (Order-nr. 13928000)
- 6.2: Sealing washer (Order-nr. 0128500M)
- 7: Non-return valve (Order-nr. 08565000)
- 8: Dirt strainer (Order-nr. 0700200M)
- 9: Extension 3/4", 20 mm (Order-nr. 0713000M)*
- 10: Screw for Costa/Avina products (Order-nr. 48013000)*
- 11: Special spanner (Order-nr. 19377000)*

* Optional accessories