

27 133 000 RELEXA 100 FIVE SHOWER RAIL SET 5 SPRAYS

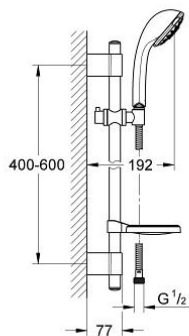

PRODUCT DESCRIPTION

- Colour: chrome
- consisting of:
 - shower rail, 600 mm (28 797)
 - GROHE FastFixation Plus adjustable distance between brackets for adaption to existing drilling holes
 - hand shower Relexa 100 Five (28 796)
 - Rotaflex TwistStop shower hose 1750 mm 1/2" x 1/2" (28 410)
 - soap dish (27 177)
 - GROHE LongLife finish
 - TwistStop - to prevent hose from twisting
- attention: old product



27 133 000 RELEXA 100 FIVE SHOWER RAIL SET 5 SPRAYS

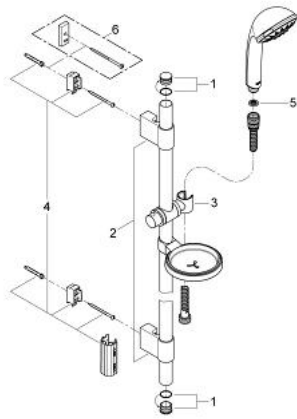

SPARE PARTS, 10月 2009 – now

- 1: Cover cap (Spare part-nr. 45922000)
- 2: Shower rail holder (Spare part-nr. 6424500M)
- 3: Glide element (Spare part-nr. 06765000)
- 4: Fixing set (Spare part-nr. 48010000)
- 5: Dirt strainer (Spare part-nr. 0700200M)
- 6: Compensation disc (Spare part-nr. 45914XE0)*

* Optional accessories