

## 27 433 000 RAINSHOWER ICON SYSTEM 190 SHOWER SYSTEM

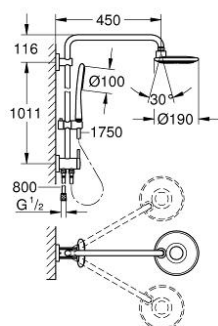

### PRODUCT DESCRIPTION

- Colour: chrome
- consists of:
  - Horizontal swivable 450 mm shower arm
  - change between hand and head shower by diverter
  - head shower Icon (27 439 000)
  - chrome plated spray plate
  - with ball joint
  - angle of rotation  $\pm 15^\circ$
  - Handshower Icon 27 276 000
  - adjustable in height with gliding element (12 140 000)
  - 9,5 l/min. flow limiter
  - connection to water supply with 1/2"-thread of the 800 mm shower hose to faucet / wall union
  - shower hose Silverflex 1750 mm (28 388)
  - minimum flow rate 7 l/min.
  - GROHE Water Saving - Less water, perfect flow
  - GROHE DreamSpray perfect spray pattern
  - GROHE Long-Life finish
  - SpeedClean anti-lime system
  - suitable for instantaneous heaters (min. 19 kW/h)



## 27 433 000 RAINSHOWER ICON SYSTEM 190 SHOWER SYSTEM

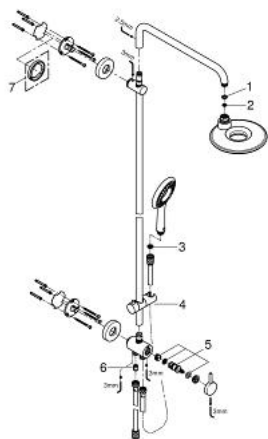

### SPARE PARTS, November 2009 – now

1: Fibre seal dia. 12x2 mm (Order-nr. 0138900M)

2: Dirt strainer (Order-nr. 48007000)

3: Dirt strainer (Order-nr. 0700200M)

4: Sliding piece (Order-nr. 12140000)

5: Repl.kit f.rotary valve (Order-nr. 45915000)

6: Non-return valve (Order-nr. 08565000)

7: Compensation disc (Order-nr. 27180000)\*

\* Optional accessories