

27 922 000 TEMPESTA COSMOPOLITAN 160 SHOWER SYSTEM WITH THERMOSTAT FOR WALL MOUNTING

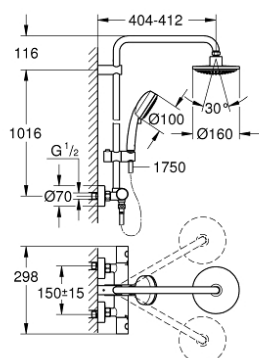

PRODUCT DESCRIPTION

- Colour: chrome
- consists of:
 - Horizontal 45° swivable 400mm shower arm
 - exposed thermostat with Aquadimmer function
 - allows change between:
 - head shower 1 spray (28 232 000)
 - spray pattern:
 - Rain
 - with ball joint
 - angle of rotation $\pm 15^\circ$
 - hand shower Tempesta Cosmopolitan 100 (27 571)
 - 2 adjustable sprays
 - Rain, Jet
 - adjustable in height with gliding element
 - shower hose Silverflex 1750 mm 1/2" x 1/2" (28 388)
 - GROHE TurboStat compact cartridge with wax thermoelement
 - GROHE SafeStop at 38°C
 - GROHE SafeStop Plus optional temperature limiter at 43°C included
 - GROHE DreamSpray perfect spray pattern
 - GROHE Long-Life finish
 - SpeedClean anti-lime system
 - Inner WaterGuide for a longer life
 - TwistStop (to prevent hose from twisting)
 - suitable for instantaneous heaters (min. 19 kW/h)
 - minimum flow rate 7 l/min.
 - optional upgrade: GROHE EasyReach tray (26 362), sold separately

27 922 000 TEMPESTA COSMOPOLITAN 160 SHOWER SYSTEM WITH THERMOSTAT FOR WALL MOUNTING



SPARE PARTS, April 2018 – now

- 1: Costa metal handle 1/2" (Order-nr. 47984000)
 - 1.1: Cap (Order-nr. 6458500M)
 - 2: Fitting ring (Order-nr. 47743000)
 - 3: Thermostatic compact cartridge 1/2" (Order-nr. 47439000)
 - 4: Sound absorber (Order-nr. 47398000)
 - 5: Water flow (Order-nr. 47751000)
 - 6: Aquadimmer (Order-nr. 12433000)
 - 7: Non-return valve (Order-nr. 47189000)
 - 7.1: Dirt Strainer (Order-nr. 0726400M)
 - 7.2: Non-return valve (Order-nr. 08565000)
 - 7.3: O-ring $\varnothing 17 \times \varnothing 2$ (Order-nr. 0305500M)
 - 8: S-union (Order-nr. 12662000)
 - 9: Non-return valve (Order-nr. 08565000)
 - 10: Sliding piece (Order-nr. 12140000)
 - 11: Dirt strainer (Order-nr. 0700200M)
 - 12: Outlet shower holder (Order-nr. 48423000)
 - 13: Fibre seal dia. 12x2 mm (Order-nr. 0138900M)
 - 14: Dirt strainer (Order-nr. 0676800M)
 - 15: Socket spanner (Order-nr. 19332000)*
 - 16: GROHE TurboStat cartridge 1/2" (Order-nr. 47175000)*
 - 17: Special spanner (Order-nr. 19377000)*
 - 18: Shower system pipe for retrofitting (Order-nr. 48053000)*
 - 19: Shower system pipe for retrofitting (Order-nr. 48054000)*
- * Optional accessories