

## 29 149 000 **SMARTCONTROL CONCEALED MIXER WITH 3 VALVES**

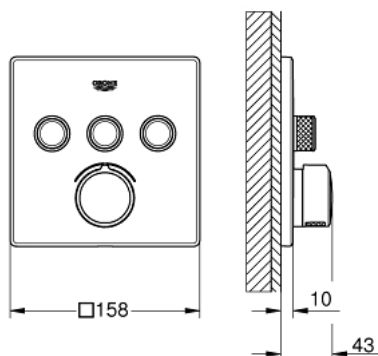

### PRODUCT DESCRIPTION

- Colour: chrome
- final installation set for
- GROHE Rapido SmartBox (35 600/35 604)
- metal wall escutcheon with GROHE FastFixation (covered escutcheon and shaft sealing, covered fixing), retroactively 6° adjustable
- GROHE Long-Life finish
- GROHE SmartControl push for ON-OFF, turn for volume adjustment from GROHE Water Saving to Full Flow
- exchangeable symbols
- cartridge for temperature mixing
- multiple outlets can be run simultaneously
- without floor installation plate
- flow performance: outlet A = 22 l/min outlet B = 26 l/min outlet C = 22 l/min outlet A + B = 31 l/min outlet A + B + C = 34 l/min



## 29 149 000 SMARTCONTROL CONCEALED MIXER WITH 3 VALVES

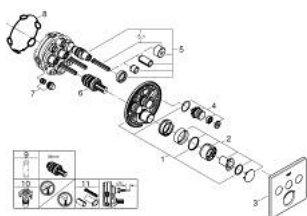

### SPARE PARTS, September 2020 – now

- 1: Mounting plate (Order-nr. 48362000)
- 2: Handle (Order-nr. 46990000)
- 3: Escutcheon (Order-nr. 46996000)
- 4: Push button (Order-nr. 48361000)
- 5: Cartridge (Order-nr. 48359000)
- 5.1: Spindle (Order-nr. 49088000)
- 6: Cartridge (Order-nr. 46989000)
- 7: Non-return valves (Order-nr. 47979000)
- 8: Ball seal dia. 9x6.8 mm (Order-nr. 48360000)
- 9: Socket spanner (Order-nr. 49059000)\*
- 10: Service stops (Order-nr. 1405300M)\*
- 11: Universal extension set single-lever mixers, 25 mm (Order-nr. 14048000)\*

\* Optional accessories