

## 31 032 BK0 GROHE F1 3-HOLE BASIN MIXER

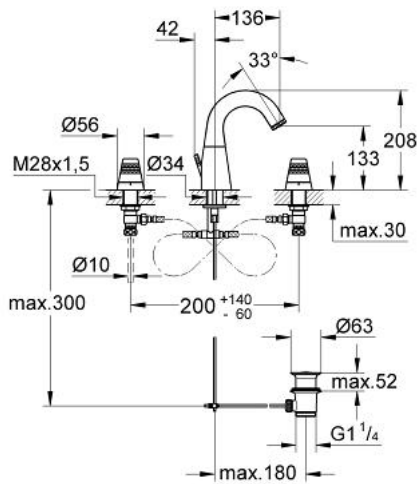

### PRODUCT DESCRIPTION

- with cone handle
- cast spout with Mousseur
- side valves with 1/2" ceramic headparts
- 180° angle
- right-closing
- pressure-proof, flexible connection hoses
- pop-up waste set 1 1/4"
- level regulation for handle gap setting



## 31 032 BK0 GROHE F1 3-HOLE BASIN MIXER

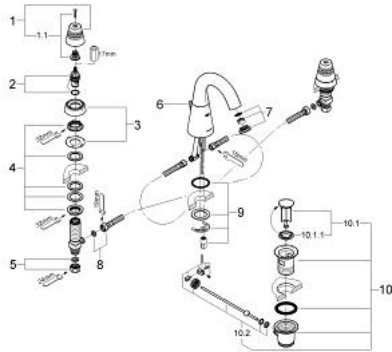

### SPARE PARTS, January 2003 – now

- 1: Handle (Spare part-nr. 45007BK0)
- 1.1: Replacement handle connection kit (Spare part-nr. 45011000)
- 2: Ceramic headpart, 1/2" (Spare part-nr. 45346000)
- 3: Escutcheon (Spare part-nr. 45015BK0)
- 4: Shank fastening assembly (Spare part-nr. 45025000)
- 5: Coupling nut 1/2" x 10.5 mm (Spare part-nr. 1290100M)
- 6: Pop-up rod (Spare part-nr. 45089BK0)
- 7: Mousseur (Spare part-nr. 45090BK0)
- 8: Flexible hose (Spare part-nr. 45442000)
- 9: Shank mounting kit (Spare part-nr. 46249000)
- 10: Pop-up waste set 1 1/4" (Spare part-nr. 28910BK0)
- 10.1: Plug (Spare part-nr. 07182BK0)
- 10.1.1: Ball seal dia. 9x6.8 mm (Spare part-nr. 0506500M)
- 10.2: Eccentric rod (Spare part-nr. 07052000)