

31 067 001 **COSTA S TWO-HANDLE SINK MIXER**

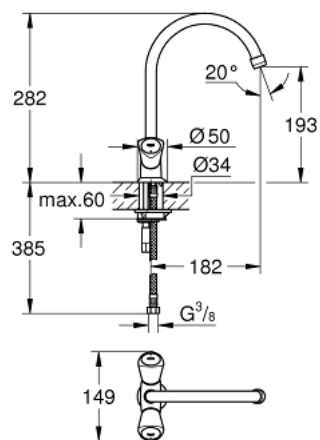

PRODUCT DESCRIPTION

- Colour: chrome
- metal handles
- heat-insulated
- screwable
- GROHE Long-Life finish
- ceramic headparts 1/2", 180°
- mousseur
- swivelling tubular spout
- selectable swivel area : 0° / 150° / 360°
- flexible connection hoses
- maximum flow rate (at 3 bar): 13 l/min
- NF approval



31 067 001 **COSTA S TWO-HANDLE SINK MIXER**

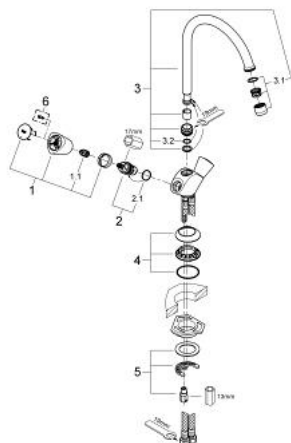

SPARE PARTS, August 2011 – now

- 1: Handle (Order-nr. 45995000)
- 1.1: Repl. kit f.handle fastening (Order-nr. 0538600M)
- 2: Ceramic headpart, 1/2" (Order-nr. 45346000)
- 2.1: O-ring $\varnothing 18.2 \times \varnothing 1.7$ (Order-nr. 0392400M)
- 3: Spout (Order-nr. 13213000)
- 3.1: Mousseur (Order-nr. 13928000)
- 3.2: O-ring dia. 12x2 mm (Order-nr. 0128000M)
- 4: Escutcheon (Order-nr. 45996000)
- 5: Shank mounting kit (Order-nr. 46249000)
- 6: Screw for Costa/Avina products (Order-nr. 48013000)*
- * Optional accessories