

31 191 001 **COSTA L WALL SINK MIXER 1/2"**

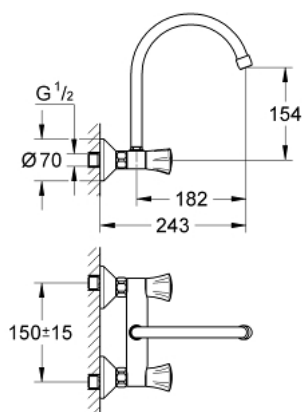

**PRODUCT DESCRIPTION**

- Colour: chrome
- wall mounted
- metal handles
- heat-insulated
- screwable
- GROHE Long-Life finish
- GROHE Long-Life headparts
- mousseur
- tubular spout
- selectable swivel area : 0° / 150° / 360°
- S-unions
- maximum flow rate (at 3 bar): 13 l/min



## 31 191 001 **COSTA L WALL SINK MIXER 1/2"**

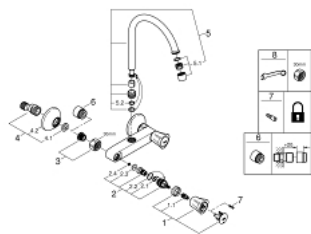

### **SPARE PARTS**, June 2007 – now

- 1: Handle (Order-nr. 45994000)
- 1.1: Repl. kit f.handle fastening (Order-nr. 0538600M)
- 2: Headpart 1/2" (Order-nr. 07146000)
- 2.1: O-ring  $\varnothing 6 \times \varnothing 2$  (Order-nr. 0128300M)
- 2.2: O-ring  $\varnothing 18.2 \times \varnothing 1.7$  (Order-nr. 0392400M)
- 2.3: Ball seal dia. 9x6.8 mm (Order-nr. 0529100M)
- 3: Screw joint (Order-nr. 45044000)
- 4: S-union (Order-nr. 12075000)
- 4.1: Ball seal dia. 9x6.8 mm (Order-nr. 0138600M)
- 4.2: Escutcheon (Order-nr. 0221000M)
- 5: Spout (Order-nr. 13213000)
- 5.1: Mousseur (Order-nr. 13928000)
- 5.2: O-ring dia. 12x2 mm (Order-nr. 0128000M)
- 6: Extension 3/4", 20 mm (Order-nr. 0713000M)\*
- 7: Screw for Costa/Avina products (Order-nr. 48013000)\*
- 8: Special spanner (Order-nr. 19377000)\*

\* Optional accessories