

32 105 00E ESSENCE SINGLE-LEVER SINK MIXER 1/2"

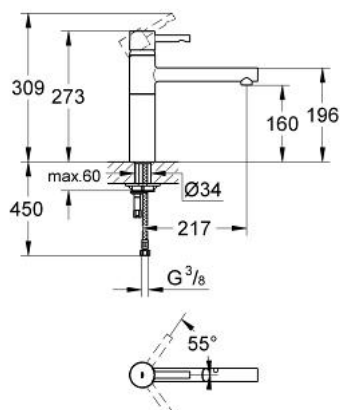

PRODUCT DESCRIPTION

- Colour: chrome
- GROHE Water Saving - Less water, perfect flow
- single hole installation
- GROHE SilkMove 35 mm ceramic cartridge
- GROHE Long-Life finish
- adjustable flow rate limiter
- adjustable minimum flow rate approx. 2.5 l/min
- swivelling tubular spout
- selectable swivel area : 0° / 150° / 360°
- mousseur
- GROHE Water Saving 5.7 l/min. flow limiter
- flexible connection hoses
- rapid-installation-system



32 105 00E **ESSENCE SINGLE-LEVER SINK MIXER 1/2"**

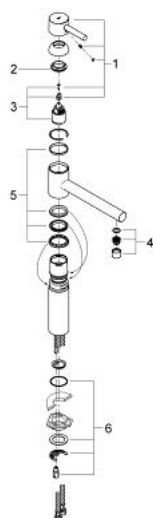

SPARE PARTS, October 2008 – now

- 1: Lever (Order-nr. 46535000)
- 2: Screw coupling (Order-nr. 46460000)
- 3: Cartridge (Order-nr. 46374000)
- 4: Mousseur (Order-nr. 13935000)
- 5: Repl. kit f. seal (Order-nr. 46429K00)
- 6: Shank mounting kit (Order-nr. 46249000)