

33 524 IP0 TARON SINGLE-LEVER BATH/SHOWER MIXER

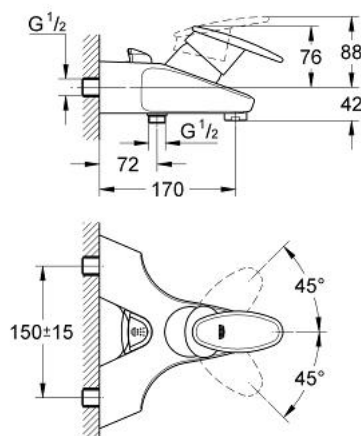

PRODUCT DESCRIPTION

- Colour: chrome/matt chrome
- wall mounted
- GROHE SilkMove 56 mm ceramic cartridge
- adjustable flow rate limiter
- automatic diverter: bath/shower
- Sistra
- integrated non-return valve in shower outlet 1/2"
- Easy-fix installation system
- optional temperature limiter ref. no. 46 308
- without shower set
- Protected against backflow
- GROHE Long-Life finish

33 524 IP0 **TARON SINGLE-LEVER BATH/SHOWER MIXER**

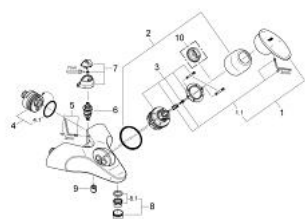

SPARE PARTS, January 1999 – now

- 1: Handle (Order-nr. 46383IP0)
- 1.1: Fixing set (Order-nr. 46372V00)
- 2: Shield (Order-nr. 46385000)
- 3: Cartridge (Order-nr. 46386000)
- 4: Straight union (Order-nr. 12081000)
- 4.1: Seal dia. 45x3 mm (Order-nr. 0044400M)
- 5: Fixing set (Order-nr. 46381V00)
- 6: Automatic diverter (Order-nr. 46107000)
- 7: Diverter knob (Order-nr. 46389000)
- 8: Sistra (Order-nr. 13907000)
- 8.1: Repl.kit f. Sistra M28x1 (Order-nr. 45047000)
- 9: Non-return valve (Order-nr. 08565000)
- 10: Temperature limiter (Order-nr. 46308000)*

* Optional accessories