

## 33 590 001 EUROSTYLE SINGLE-LEVER SHOWER MIXER

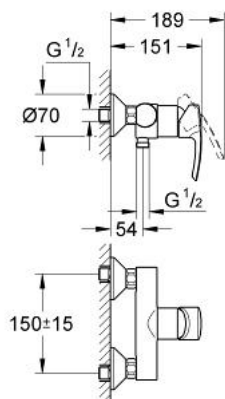

### PRODUCT DESCRIPTION

- Colour: chrome
- metal lever
- wall mounted
- GROHE SilkMove 46 mm ceramic cartridge
- GROHE Long-Life finish
- adjustable flow rate limiter
- adjustable minimum flow rate approx. 2.5 l/min
- shower outlet below 1/2" with integrated non return-valve
- S-unions
- metal wall escutcheons
- Protected against backflow
- optional temperature limiter ref. no. 46 375
- noise classification 1 in accordance with DIN4109

## 33 590 001 **EUROSTYLE SINGLE-LEVER SHOWER MIXER**

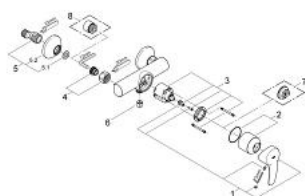

### **SPARE PARTS**, January 2011 – now

- 1: Lever (Order-nr. 46577000)
- 2: Shield (Order-nr. 46578000)
- 3: Cartridge (Order-nr. 46048000)
- 4: Screw joint (Order-nr. 45044000)
- 5: S-union (Order-nr. 12075000)
- 5.1: Ball seal dia. 9x6.8 mm (Order-nr. 0138600M)
- 5.2: Escutcheon (Order-nr. 0221000M)
- 6: Non-return valve (Order-nr. 08565000)
- 7: Temperature limiter (Order-nr. 46375000)\*
- 8: Extension 3/4", 20 mm (Order-nr. 0713000M)\*

\* Optional accessories