

33 598 IP0 TARON SINGLE-LEVER SHOWER MIXER 1/2"

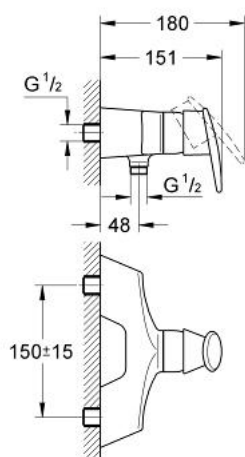

PRODUCT DESCRIPTION

- Colour: chrome/ matt chrome
- wall mounted
- GROHE SilkMove 46 mm ceramic cartridge
- adjustable flow rate limiter
- shower bottom outlet 1/2"
- integrated non-return valve in the shower outlet 1/2"
- eccentric connection system
- optional temperature limiter ref. no. 46 308
- without shower set
- protected against backflow
- GROHE Long-Life finish

33 598 IP0 **TARON SINGLE-LEVER SHOWER MIXER 1/2"**

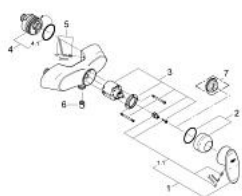

SPARE PARTS, 1月 2002 – now

1: Handle (Order-nr. 46378IP0)

1.1: Fixing set (Order-nr. 46372V00)

2: Cap (Order-nr. 46242000)

3: Cartridge (Order-nr. 46048000)

4: Pillar union, straight (Order-nr. 12081000)

4.1: Seal Ø45 x Ø3 (Order-nr. 0044400M)

5: Fixing set (Order-nr. 46381V00)

6: Non-return valve (Order-nr. 45481000)

7: Temperature limiter (Order-nr. 46308000)*

* Optional accessories