

33 635 001 EUROSTYLE SINGLE-LEVER SHOWER MIXER

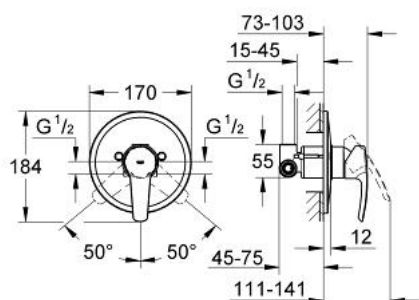

PRODUCT DESCRIPTION

- Colour: chrome
- wall installation
- consists of:
 - set for final installation (19 507 001)
 - concealed body (33 964)
 - GROHE SilkMove 46 mm ceramic cartridge
 - GROHE Long-Life finish
 - adjustable flow rate limiter
 - adjustable minimum flow rate approx. 2.5 l/min
 - metal lever
 - metal wall escutcheon
 - screwed
 - optional temperature limiter ref. no. 46 375



33 635 001 EUROSTYLE SINGLE-LEVER SHOWER MIXER

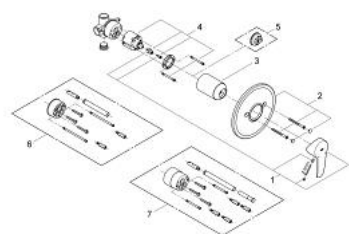

SPARE PARTS, August 2005 – now

1: Lever (Order-nr. 46577000)

2: Escutcheon (Order-nr. 46469000)

3: Shield (Order-nr. 06874000)

4: Cartridge (Order-nr. 46048000)

5: Temperature limiter (Order-nr. 46308000)*

6: Extension set (Order-nr. 46191000)*

7: Extension set (Order-nr. 46343000)*

* Optional accessories