

33 637 001 EUROSTYLE SINGLE-LEVER BATH/SHOWER MIXER

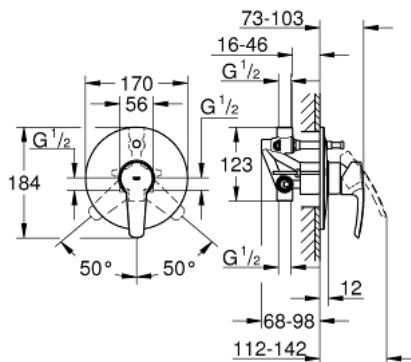

PRODUCT DESCRIPTION

- Colour: chrome
- wall installation
- consists of:
 - set for final installation (19 506 001)
 - concealed body(33 963)
 - GROHE SilkMove 46 mm ceramic cartridge
 - GROHE Long-Life finish
 - adjustable flow rate limiter
 - adjustable minimum flow rate approx. 2.5 l/min
 - automatic diverter: bath/shower
 - metal lever
 - metal wall escutcheon
 - screwed
 - optional temperature limiter ref. no. 46 375



33 637 001 EUROSTYLE SINGLE-LEVER BATH/SHOWER MIXER

SPARE PARTS, August 2005 – now

- 1: Lever (Order-nr. 46577000)
- 2: Escutcheon (Order-nr. 46468000)
- 3: Shield (Order-nr. 06874000)
- 4: Diverter (Order-nr. 46058000)
- 4.1: Diverter knob (Order-nr. 46008000)
- 4.2: O-ring $\varnothing 6 \times \varnothing 2$ (Order-nr. 0128300M)
- 5: Cartridge (Order-nr. 46048000)
- 6: Temperature limiter (Order-nr. 46375000)*
- 7: Extension set (Order-nr. 46191000)*
- 8: Extension set (Order-nr. 46343000)*

* Optional accessories

