

## 34 281 000 COMFORT SET GROHTHERM 2000

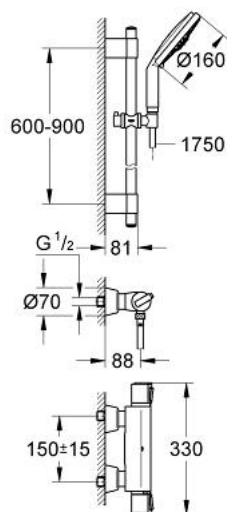

### PRODUCT DESCRIPTION

- Colour: chrome
- consists of:
  - Grotherm 2000 thermostat shower mixer(34 169)
  - GROHE CoolTouch safety housing
  - GROHE TurboStat compact cartridge with wax thermoelement
  - integrated mixed water shut off
  - ceramic headpart 1/2", 180°
  - volume handle with EcoButton (economy button with individually adjustable economy stop)
  - GROHE SafeStop at 38°C
  - covered S-unions
  - Protected against backflow
  - Rainshower Cosmopolitan shower set with GROHE DreamSpray
  - shower rail 900 mm 28 819 001
  - GROHE FastFixation (adjustable distance between wall shower holders for adaption to existing drillings)
  - handshower Cosmopolitan 28 756 000
  - 4 spray patterns
  - Rain / Jet / Pure / Champagne
  - SpeedClean anti-lime system
  - shower hose Silverflex 1750 mm(28 388)
  - TwistStop (to prevent hose from twisting)
  - GROHE Water Saving - Less water, perfect flow
  - GROHE Long-Life finish

## 34 281 000 COMFORT SET GROHTHERM 2000

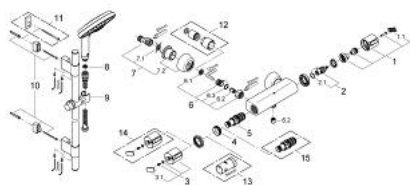

### SPARE PARTS, October 2007 – now

- 1: Handle for shut-off valve with economy device (Order-nr. 47745000)
- 1.1: Cap (Order-nr. 1007500M)
- 2: Ceramic headpart, 1/2" (Order-nr. 45346000)
- 2.1: O-ring  $\varnothing 18.2 \times \varnothing 1.7$  (Order-nr. 0392400M)
- 3: Scale handle (Order-nr. 47742000)
- 3.1: Cap (Order-nr. 1007500M)
- 4: Fitting ring (Order-nr. 47743000)
- 5: Thermostatic compact cartridge 1/2" (Order-nr. 47439000)
- 6: Non-return valve (Order-nr. 47189000)
- 6.1: Dirt Strainer (Order-nr. 0726400M)
- 6.2: Non-return valve (Order-nr. 08565000)
- 6.3: O-ring  $\varnothing 17 \times \varnothing 2$  (Order-nr. 0305500M)
- 7: S-union (Order-nr. 12058000)
- 7.1: Ball seal dia. 9x6.8 mm (Order-nr. 0138600M)
- 7.2: Covering escutcheon (Order-nr. 45545000)
- 8: Dirt strainer (Order-nr. 0700200M)
- 9: Sliding piece (Order-nr. 06765000)
- 10: Fixing set (Order-nr. 45403000)
- 11: Compensation disc (Order-nr. 45914VT0)\*
- 12: Extension set 1/2", 30 mm (Order-nr. 46238000)\*
- 13: Socket spanner (Order-nr. 19332000)\*
- 14: Scale handle (Order-nr. 47286000)\*
- 15: GROHE TurboStat cartridge 1/2" (Order-nr. 47175000)\*

\* Optional accessories