

## 34 282 000 COMFORT SET GROHTHERM 2000



### PRODUCT DESCRIPTION

- Colour: chrome
- consisting of:
  - Grotherm 2000 set for final installation (19 354)
  - GROHE SafeStop safety button at 38°C
  - volume handle with GROHE EcoButton (economy button with individually adjustable economy stop)
  - Carbodur ceramic headpart 1/2", 180°
  - metal escutcheon
  - covered coupling
  - GROHE Rapido T thermostatic mixer for concealed installation (35 500)
  - installation depth 70 - 95 mm
  - easy to install, premounted and tested unit
  - GROHE TurboStat compact cartridge with wax thermoelement
  - body made of DR brass
  - built-in non return valves
  - Rainshower Cosmopolitan shower set with GROHE DreamSpray
  - shower rail, 900 mm (28 819 001)
  - GROHE FastFixation Plus (adjustable distance between wall shower holders for adaption to existing drillings)
  - hand shower Cosmopolitan (28 756 000)
  - 4 spray patterns:
    - Rain, Jet, Pure, Champagne spray
  - SpeedClean anti-limescale system
  - Silverflex shower hose 1750 mm 1/2" x 1/2" (28 388)
  - TwistStop to prevent hose from twisting
  - shower outlet elbow (28 626)
  - GROHE Water Saving - Less water, perfect flow
  - GROHE Long-Life finish

## 34 282 000 COMFORT SET GROHTHERM 2000

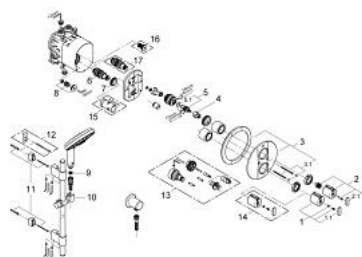

### SPARE PARTS, 10月 2007 – now

- 1: Temperature scale handle (Order-nr. 47742000)
- 1.1: Cover cap (Order-nr. 1007500M)
- 2: Handle for shut-off valve with economy device (Order-nr. 47745000)
- 2.1: Cover cap (Order-nr. 1007500M)
- 3: Escutcheon (Order-nr. 47749000)
- 3.1: Set of screws (Order-nr. 46088000)
- 4: Stop (Order-nr. 10093000)
- 5: Ceramic headpart 1/2" (Order-nr. 45346000)
- 5.1: O-ring Ø 18.2 x Ø 1.7 (Order-nr. 0392400M)
- 6: Thermostatic compact cartridge 3/4" (Order-nr. 47483000)
- 7: Fitting ring (Order-nr. 47765000)
- 8: Non-return valve (Order-nr. 47753000)
- 9: Dirt strainer (Order-nr. 0700200M)
- 10: Glide element (Order-nr. 06765000)
- 11: Fixing set (Order-nr. 45403000)
- 12: Compensation disc (Order-nr. 45914VT0)\*
- 13: Extension set 27.5 mm (Order-nr. 47780000)\*
- 14: Temperature scale handle (Order-nr. 47286000)\*
- 15: Socket spanner (Order-nr. 19332000)\*
- 16: Safety combination (EN 1717) (Order-nr. 29007000)\*
- 17: Thermostatic compact cartridge 3/4" for reverse waterways (Order-nr. 47186000)\*

\* Optional accessories