

## 36 088 000 ESSENCE E INFRA-RED ELECTRONIC BASIN MIXER 1/2" WITH MIXING DEVICE AND ADJUSTABLE TEMPERATURE LIMITER

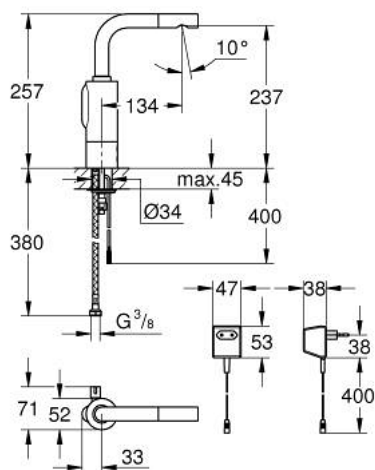

### PRODUCT DESCRIPTION

- Colour: chrome
- single hole installation
- with plug transformer 230 V, 50 Hz, 3,2 VA
- GROHE Long-Life finish
- GROHE Water Saving 5.0 l/min flow limiter
- integrated mousseur
- solenoid valve integrated in housing
- flexible connection hoses
- dirt strainers
- rapid installation system
- automatic safety stop after 60 sec. (factory set)
- additional functions and precise settings by remote control 36 407
- automatic flushing after 1 or 3 days without use
- activation of permanent run for thermal disinfection for 3.5 or 11 min
- CE approved
- noise classification I in accordance with DIN 4109
- type of protection faucet IP 59K



## 36 088 000 ESSENCE E INFRA-RED ELECTRONIC BASIN MIXER 1/2" WITH MIXING DEVICE AND ADJUSTABLE TEMPERATURE LIMITER

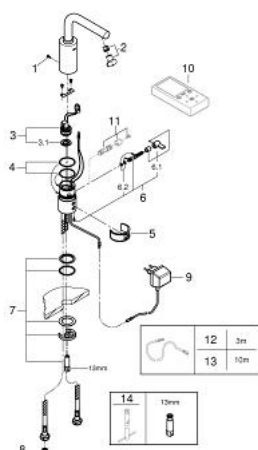

### SPARE PARTS, 6月 2016 – now

- 1: Screws (Order-nr. 4283100M)
- 2: Mousseur (Order-nr. 13943000)
- 3: Solenoid valve (Order-nr. 43066000)
- 3.1: Dirt strainer (Order-nr. 42798000)
- 4: Sealing washer (Order-nr. 4283600M)
- 5: Cleaning clip (Order-nr. 42837000)
- 6: Mixer spindle with lever (Order-nr. 42363000)
- 6.1: Mixing lever (Order-nr. 42364000)
- 6.2: Sealing washer (Order-nr. 4284000M)
- 7: Fixing set (Order-nr. 42841000)
- 8: Filter (Order-nr. 4241300M)
- 9: Plug transformer (Order-nr. 43016000)
- 10: Remote control (Order-nr. 36407001)\*
- 11: Hidden mixing device (Order-nr. 36209000)\*
- 12: Extension cable (Order-nr. 36221000)\*
- 13: Extension cable (Order-nr. 36222000)\*
- 14: Mounting wrench (Order-nr. 19017000)\*

\* Optional accessories