

36 243 SD0 EUROPLUS E INFRARED ELECTRONIC BASIN MIXER 1/2"

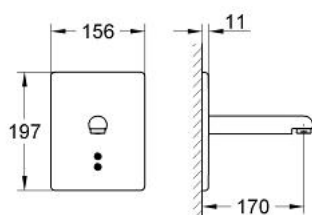

PRODUCT DESCRIPTION

- Colour: stainless steel
- final installation set for concealed fitting box
- 36 009
- 36 241
- IR-electronic with detection in the handwashing area
- transformer 230 V (initial voltage of control)
- automatic safety stop 60 sec.(factory pre-set)
- temporary stop-function for 3 minutes (cleaning modus) activatel over sensoric
- Functions to activate with remote control 36 206:
- automatic flushing after 1 or 3 days without use
- Thermal disinfection for 3,5 or 11 min
- stainless steel escutcheon
- stainless steel spout 170 mm
- flow straightener 9 l/min.
- type of protection IP 54
- noise classification 1 in accordance with DIN4109
- CE approved
- GROHE Water Saving - Less water, perfect flow
- without concealed body

36 243 SD0 EUROPLUS E INFRARED ELECTRONIC BASIN MIXER 1/2"

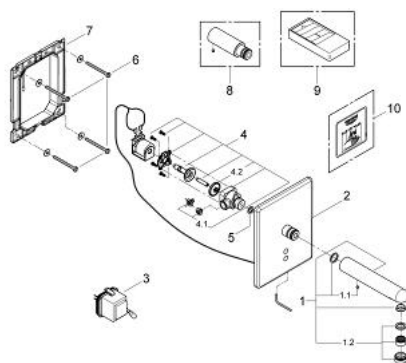

SPARE PARTS, January 2009 – now

- 1: Spout (Order-nr. 42121SD0)
- 1.1: Screw dia. 4x52 mm (Order-nr. 43094000)
- 1.2: Flow straightener (Order-nr. 13960000)
- 2: Cover plate Europlus E incl.electronic (Order-nr. 42122SD0)
- 3: Transformer (Order-nr. 42278000)
- 4: Solenoid valve (Order-nr. 42123000)
- 4.1: Dirt Strainer (Order-nr. 4215200M)
- 4.2: Membrane (Order-nr. 43809000)
- 5: Fibre seal dia. 12x2 mm (Order-nr. 0138900M)
- 6: Fixing set (Order-nr. 4308500M)
- 7: Frame (Order-nr. 42736000)
- 8: Outlet extension (Order-nr. 42126SD0)*
- 9: Infra-red remote control (Order-nr. 36206000)*
- 10: Sticker with pictograph (Order-nr. 4217700M)
- * Optional accessories